

6RA7013-6D V 6 2-0	400 V	15 A
6RA7018-6D □□ 2-0	400 V	30 A
6RA7025-6D □□ 2-0	400 V	60 A
6RA7028-6D □□ 2-0	400 V	90 A
6RA7031-6D □□ 2-0	400 V	125 A

▲ S 2 DB (Single-/two-quadrant operation)  
■ V 6 GDB (Four-quadrant operation)

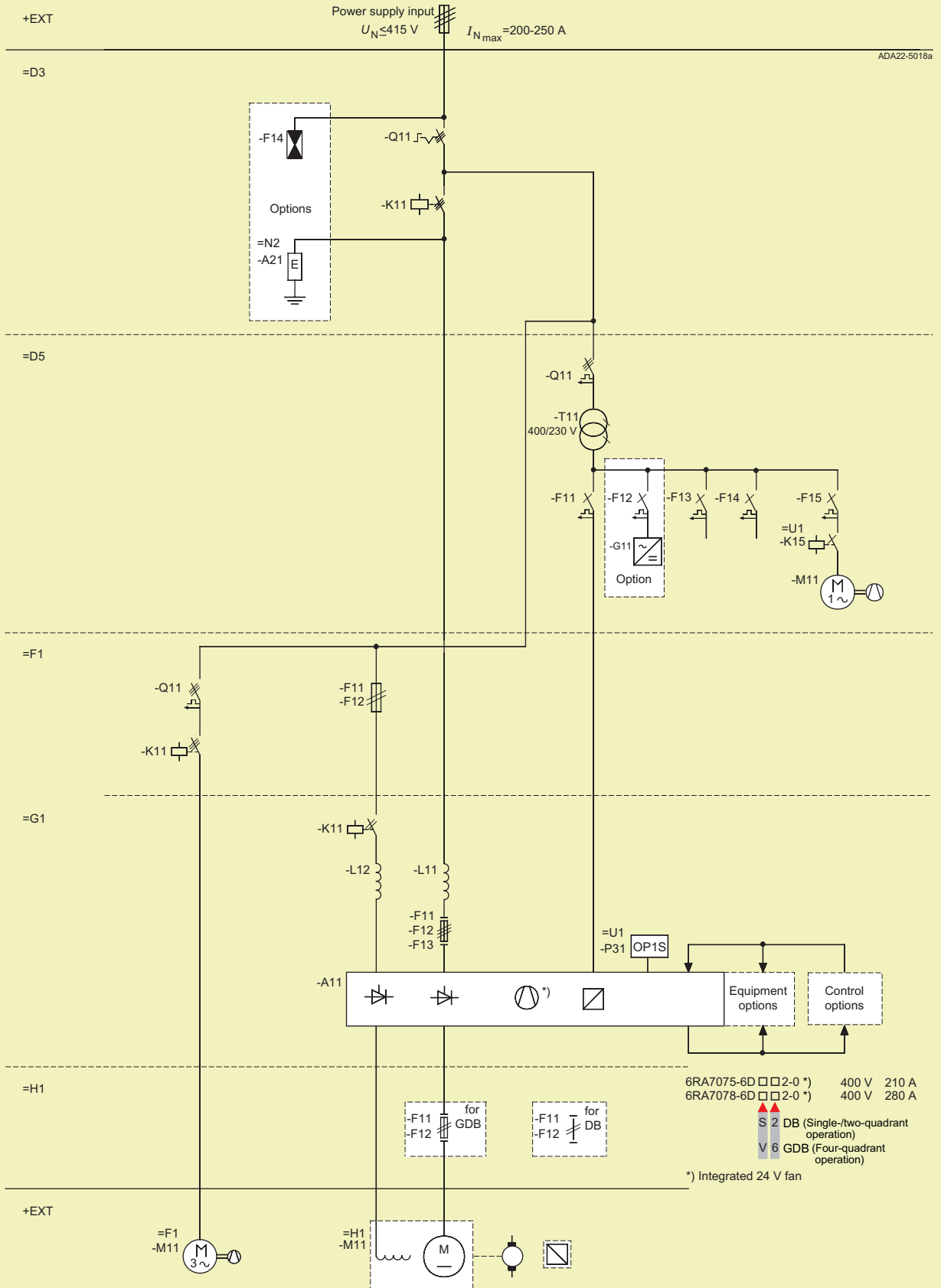

# With SIMOREG DC MASTER 400 A to 850 A, 400 V

ADA22-5019a

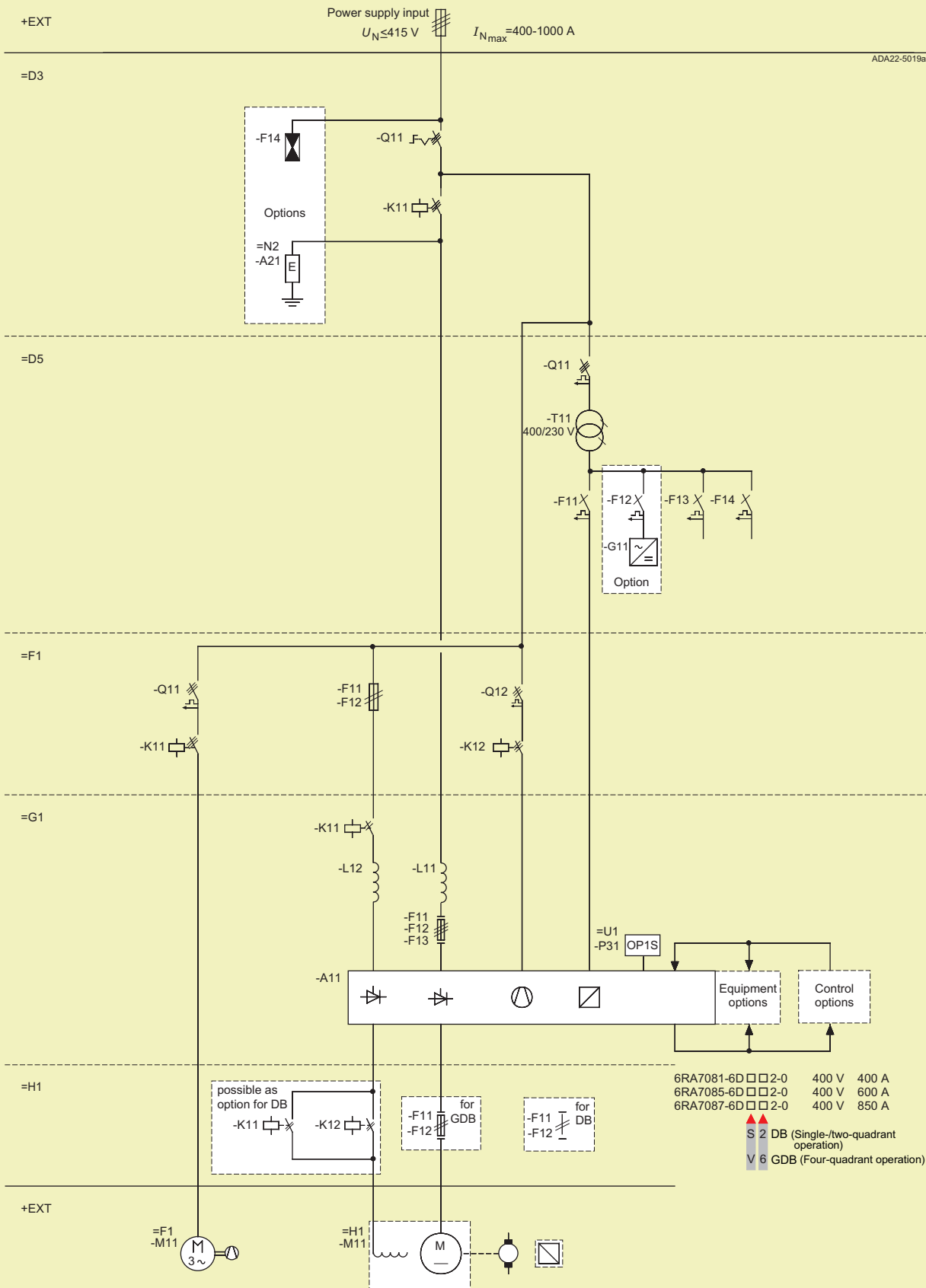

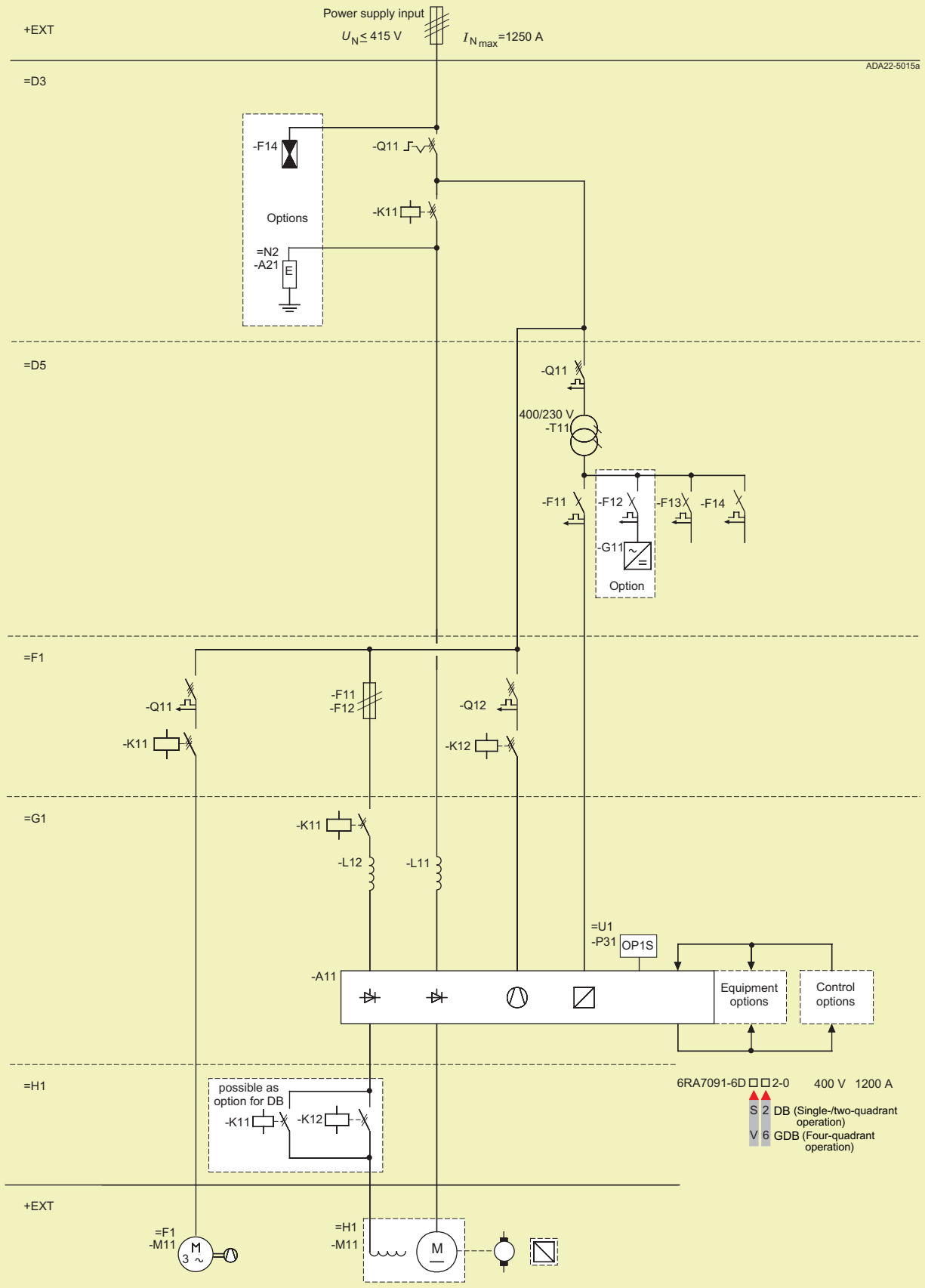

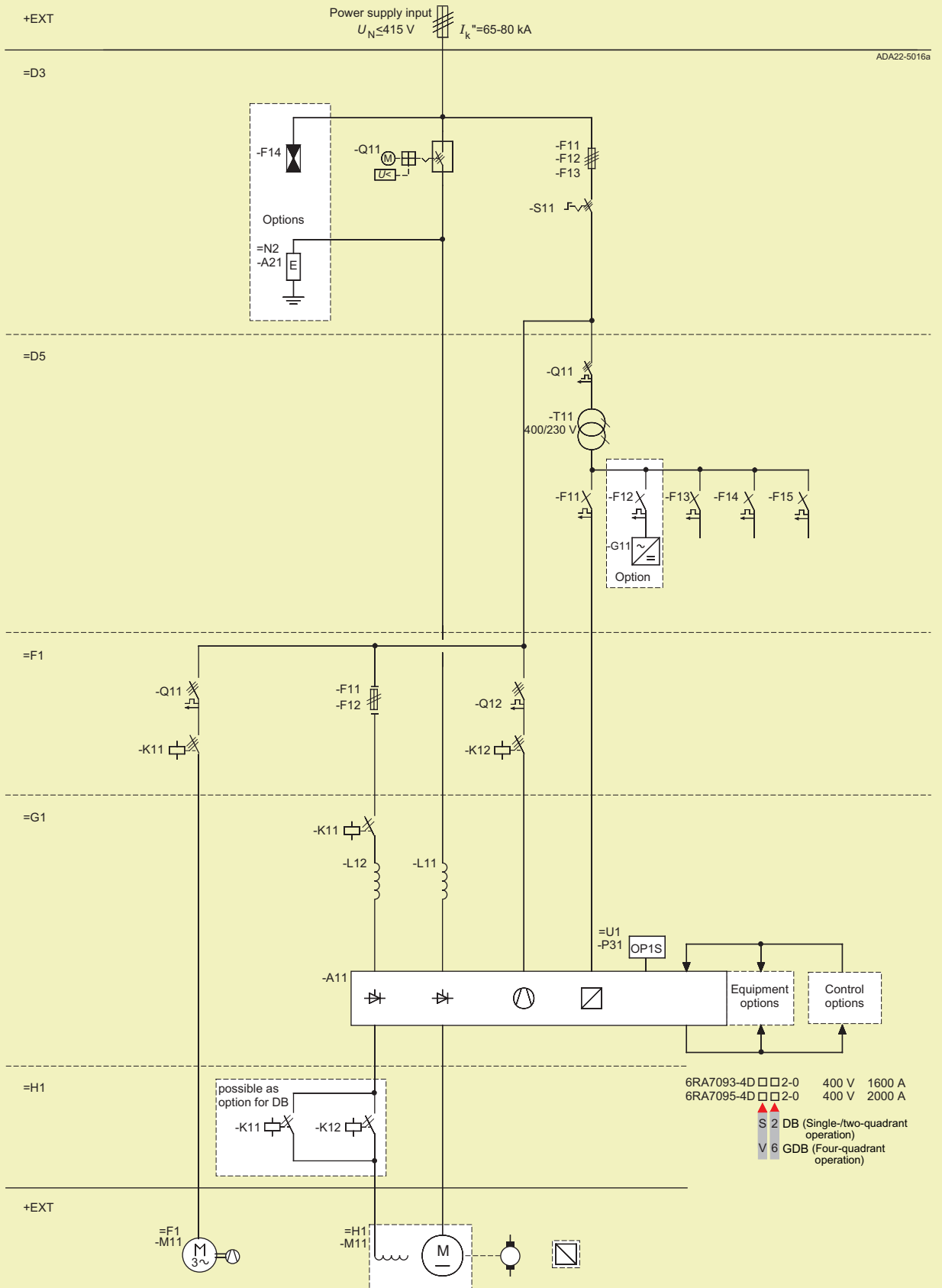

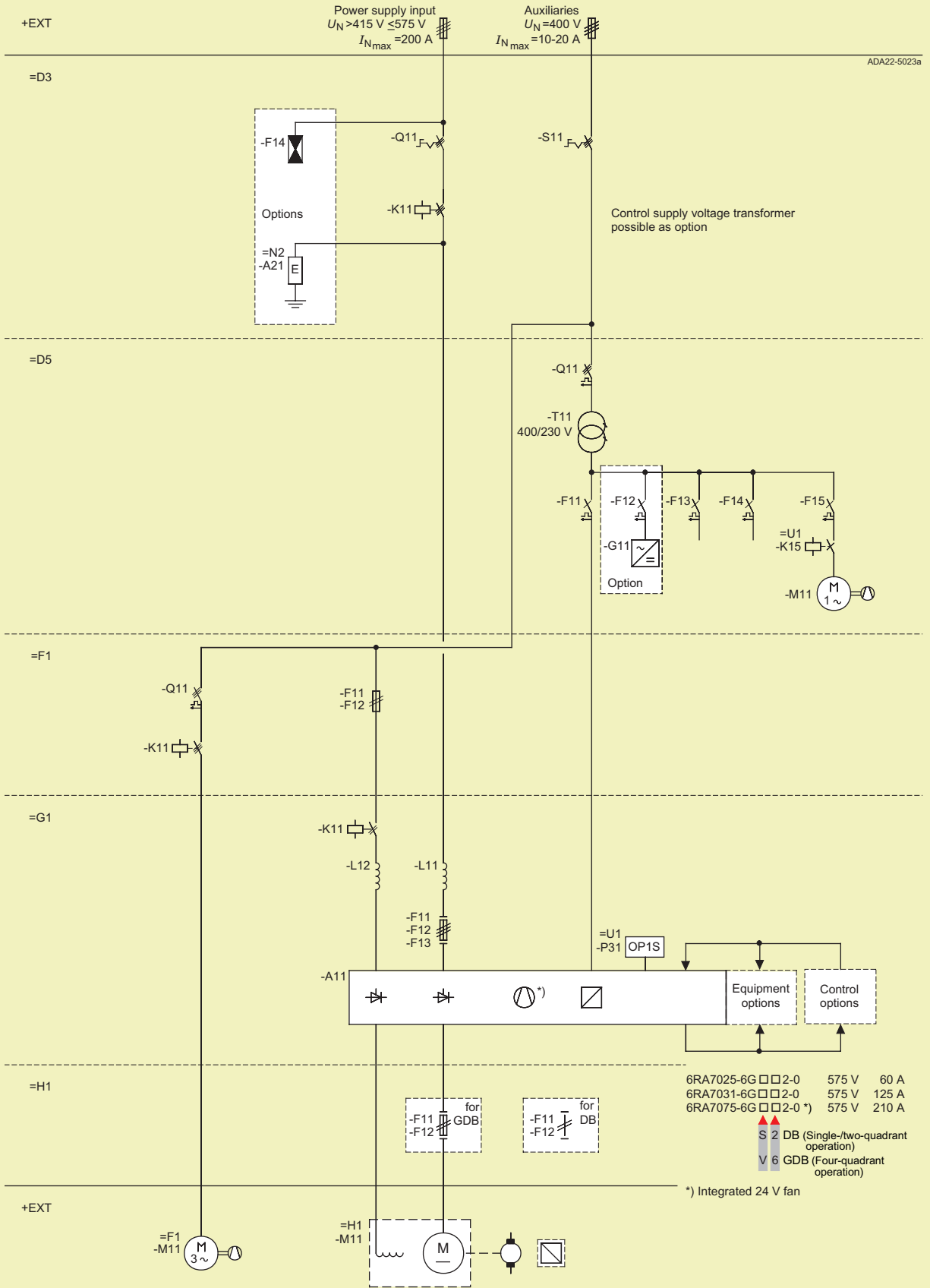

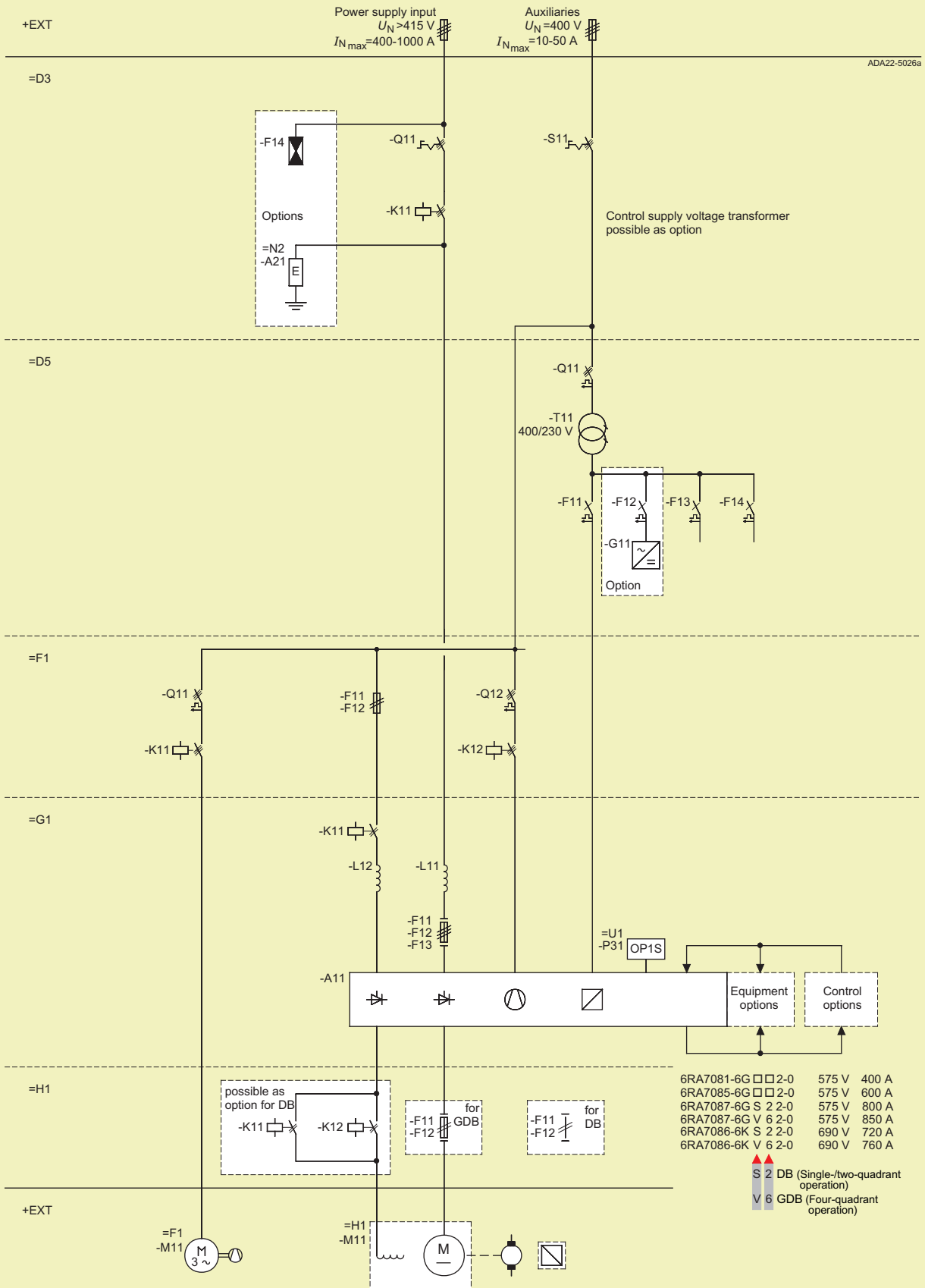

6RA7081-6G	□ □ 2-0	575 V	400 A
6RA7085-6G	□ □ 2-0	575 V	600 A
6RA7087-6G	S 2 2-0	575 V	800 A
6RA7087-6G	V 6 2-0	575 V	850 A
6RA7086-6K	S 2 2-0	690 V	720 A
6RA7086-6K	V 6 2-0	690 V	760 A

▲ S 2 DB (Single-/two-quadrant operation)  
▲ V 6 GDB (Four-quadrant operation)

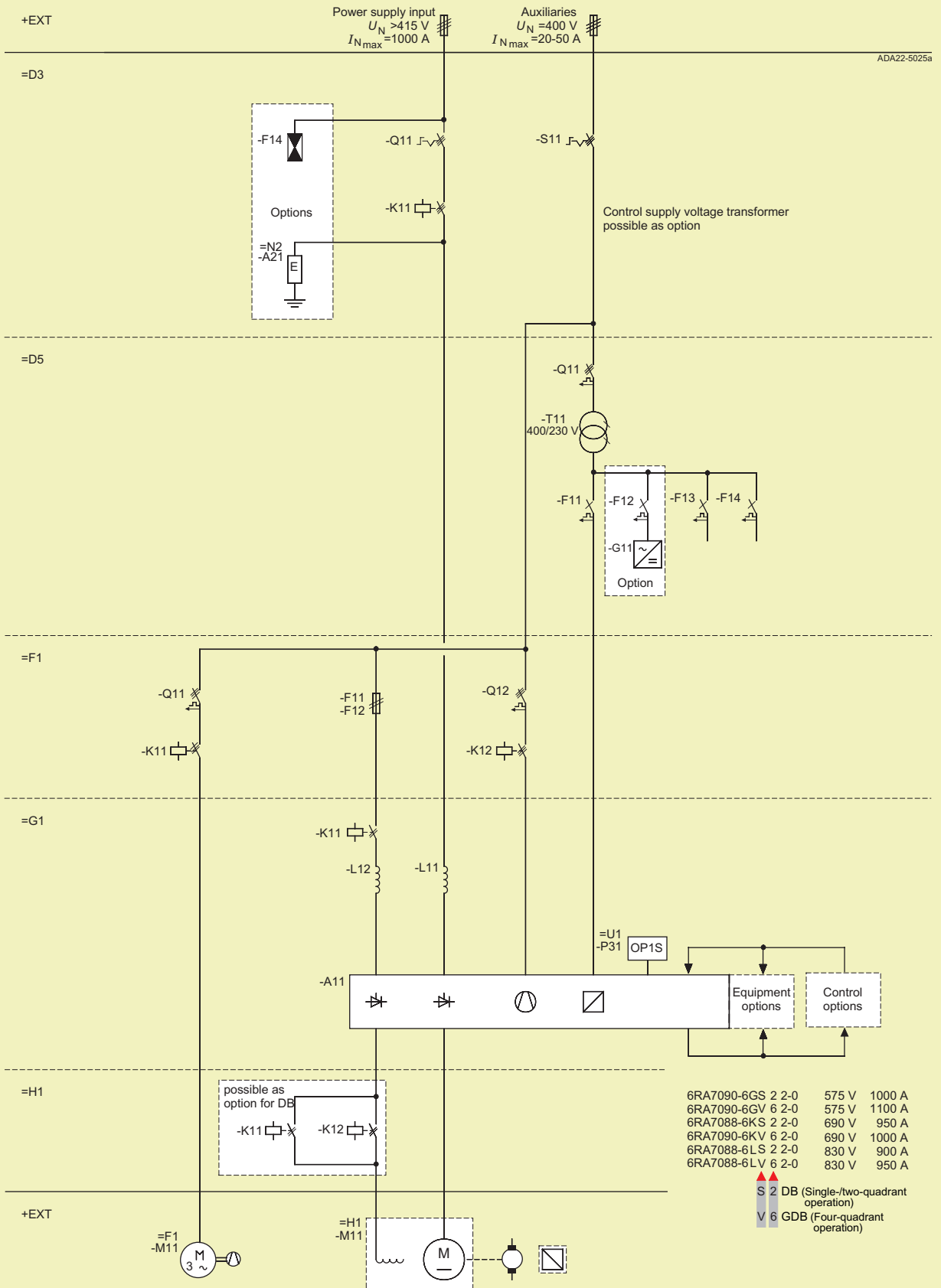

6RA7090-6GS 2 2-0	575 V	1000 A
6RA7090-6GV 6 2-0	575 V	1100 A
6RA7088-6KS 2 2-0	690 V	950 A
6RA7090-6KV 6 2-0	690 V	1000 A
6RA7088-6LS 2 2-0	830 V	900 A
6RA7088-6LV 6 2-0	830 V	950 A

S 2 DB (Single-/two-quadrant operation)  
 V 6 GDB (Four-quadrant operation)



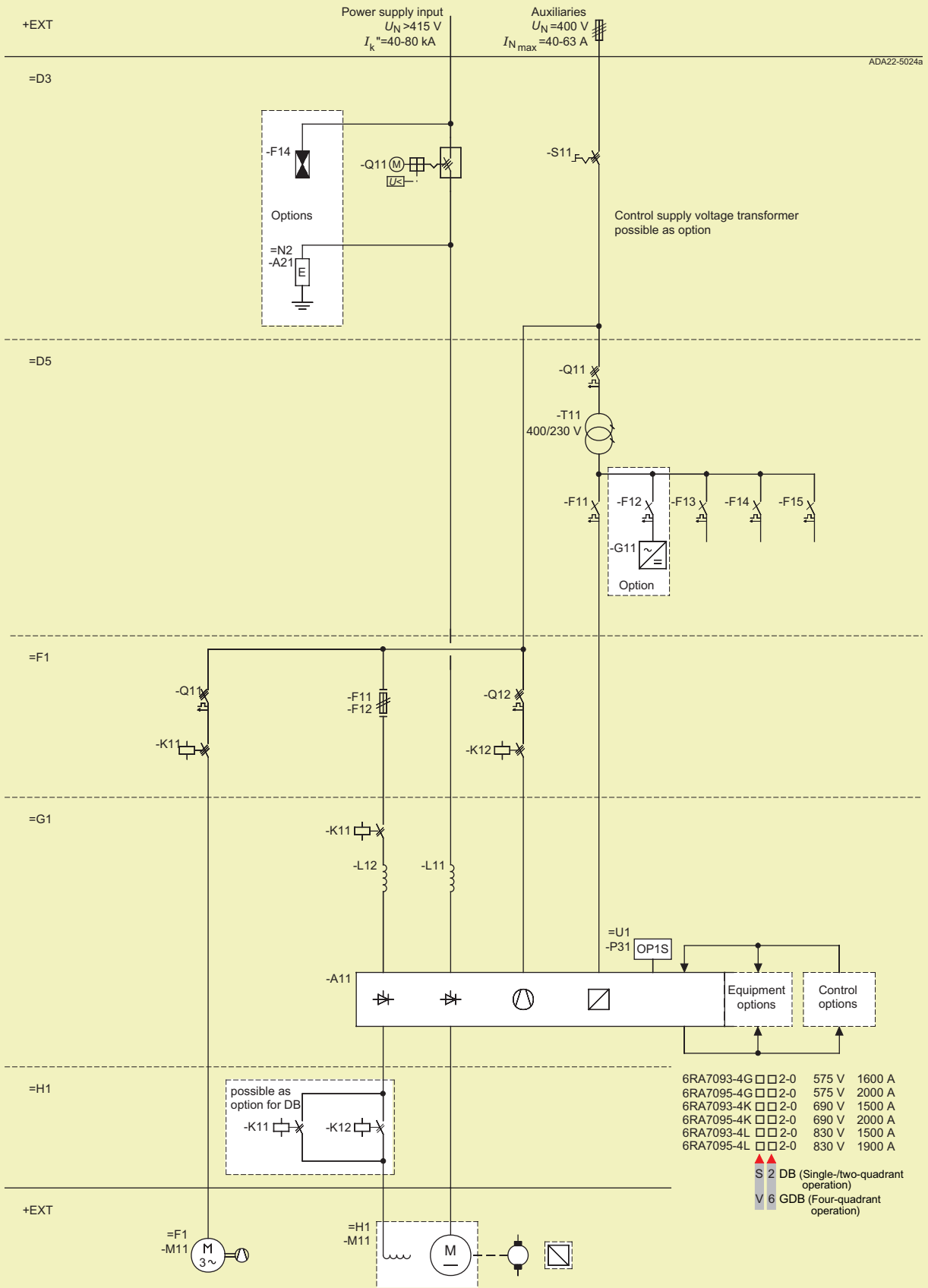

ADA22-5024a

6RA7093-4G	□ □ 2-0	575 V	1600 A
6RA7095-4G	□ □ 2-0	575 V	2000 A
6RA7093-4K	□ □ 2-0	690 V	1500 A
6RA7095-4K	□ □ 2-0	690 V	2000 A
6RA7093-4L	□ □ 2-0	830 V	1500 A
6RA7095-4L	□ □ 2-0	830 V	1900 A

▲ S 2 DB (Single-/two-quadrant operation)  
▲ V 6 GDB (Four-quadrant operation)

