

**Accessories**

Order No.

**Weld in connection fittings for MAG 1100 F with P gaskets for EHEDG**

Only for sensors with PFA liner.

2 pcs. fittings  
2 pcs. clamps (to join flow sensor and fitting)**DIN 11850**

Adapter			Sensor
DN (mm)	D <sub>o</sub> (mm)	D <sub>i</sub> (mm)	DN (mm)

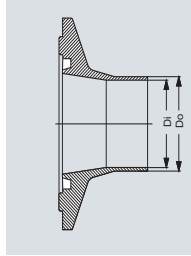

10	13	10	10	◆ A5E02054630
15	19	16	15	◆ A5E02054633
20	23	20	15	A5E02054634
25	29	26	25	◆ A5E02054635
32	35	32	25	A5E02054637
40	41	38	40	◆ A5E02054638
50	53	50	50	◆ A5E02054640
65	70	66	65	◆ A5E02054643
80	85	81	80	◆ A5E02054644
100	104	100	100	◆ A5E02054646

**ISO 2037 (SMS3008)**

Adapter			Sensor
DN (mm)	D <sub>o</sub> (mm)	D <sub>i</sub> (mm)	DN (mm)

10	13	10	10	◆ A5E02054630
15	19	16	15	◆ A5E02054633
25	25.6	22.6	25	◆ A5E02196073
28	28.6	25.6	25	A5E02196074
38	38.6	35.6	40	◆ A5E02196075
40	40.6	37.6	40	◆ A5E02196076
51	51.6	48.6	50	◆ A5E02196077
63.5	64.1	60.3	65	◆ A5E02196078
76.1	76.7	72.9	80	◆ A5E02196080
101.6	102.5	97.6	100	A5E02196082

**Tri-Weld (BS 4825-1)**

Adapter			Sensor
DN (mm)	D <sub>o</sub> (mm)	D <sub>i</sub> (mm)	DN (mm)

10	12.7	9.4	10	A5E02199113
15.9	19.05	15.75	15	A5E02199114
25	25.4	22.1	25	A5E02199115
38	38.1	34.8	40	A5E02199116
51	50.8	47.5	50	A5E02199117
63.5 <sup>1)</sup>	63.5	60.2	65	A5E02199118
76.1	76.2	72.9	80	A5E02199119
102 <sup>1)</sup>	101.6	97.38	100	A5E02199120

◆ Short lead time (details in PMD)

D<sub>o</sub>: outer diameterD<sub>i</sub>: inner diameter<sup>1)</sup> For BS 4825-1 see ISO 2037**Accessories**

Order No.

**Clamp-type connection fittings for MAG 1100 F with P gaskets for EHEDG**

Only for sensors with PFA liner.

2 pcs. fittings  
2 pcs. clamps (to join flow sensor and fitting)**DIN 32676**

Adapter			Sensor
DN (mm)	D <sub>o</sub> (mm)	D <sub>i</sub> (mm)	DN (mm)

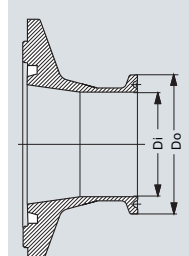

10	34	10	10	A5E02211143
15	34	16	15	A5E02211144
25	50.5	26	25	A5E02211146
40	50.5	38	40	A5E02211147
50	64	50	50	A5E02211148
65	91	66	65	A5E02211151
80	106	81	80	A5E02211152
100	119	100	100	A5E02211153

**ISO 2852 (SMS 3016, BS 4825-3)**

Adapter			Sensor
DN (mm)	D <sub>o</sub> (mm)	D <sub>i</sub> (mm)	DN (mm)

10	34	10	10	A5E02211143
15	34	16	15	A5E02211144
25	50.5	26	25	A5E02213581
33.7	50.5	31.3	25	A5E02213582
38	50.5	35.6	40	A5E02213583
51	64	48.6	50	A5E02213584
63.5	77.5	60.3	65	A5E02213585
76.1	91	72.9	80	A5E02213586
101.6	119	97.6	100	A5E02213587

**Tri-Clamp**

Adapter			Sensor
DN (mm)	D <sub>o</sub> (mm)	D <sub>i</sub> (mm)	DN (mm)

10	25	10	10	A5E02213596
15	25	16	15	A5E02213597
25	50.5	22.6	25	A5E02213598
38	50.5	35.6	40	A5E02213599
51	64	48.6	50	◆ A5E02213600
63.5	77.5	60.3	65	A5E02213601
76.1	91	72.9	80	◆ A5E02213602
101.6	119	97.6	100	A5E02213603

◆ Short lead time (details in PMD)

D<sub>o</sub>: outer diameterD<sub>i</sub>: inner diameter

**Threaded type connection fittings for  
MAG 1100 F with P gaskets for EHEDG**

Only for sensors with PFA liner.

2 pcs. fittings

2 pcs. clamps (to join flow sensor and fitting)

**DIN 11851**Adapter

DN (mm)

D<sub>o</sub> (mm)D<sub>i</sub> (mm)Sensor

DN (mm)

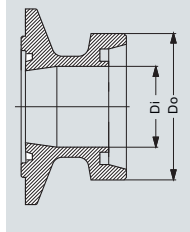

10	28	10	10
15	34	16	15
20	44	20	15
25	52	26	25
32	58	32	25
40	65	38	40
50	78	50	50
65	95	66	65
80	110	81	80
100	130	100	100

**A5E02218293****A5E02218294****A5E02218295**◆ **A5E02218296****A5E02218297**◆ **A5E02218298**◆ **A5E02218299****A5E02218300****A5E02218301****A5E02218302****Threaded type connection fittings for  
MAG 1100 F with P gaskets for EHEDG**

Only for sensors with PFA liner.

2 pcs. fittings

2 pcs. clamps (to join flow sensor and fitting)

**SMS 1145**Adapter

DN (mm)

D<sub>o</sub> (mm)D<sub>i</sub> (mm)Sensor

DN (mm)

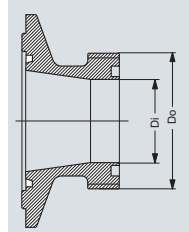

25	40	22.6	25
38	60	35.6	40
51	70	48.6	50
63.5	85	60.3	65
76	98	72	65

**A5E02218310****A5E02218312****A5E02218313****A5E02218314****A5E02218315**

◆ Short lead time (details in PMD)

D<sub>o</sub>: outer diameterD<sub>i</sub>: inner diameter

**Weld in connection fittings for MAG 1100 F with flat gaskets for 3A**

For sensors with ceramic and PFA liner.

2 pcs. fittings  
2 pcs. clamps (to join flow sensor and fitting)**DIN 11850**

Adapter			Sensor
DN (mm)	D <sub>o</sub> (mm)	D <sub>i</sub> (mm)	DN (mm)

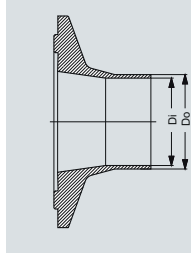

10	13	10	10	◆ FDK-083G2116
15	19	16	15	◆ FDK-083G2117
20	23	20	15	◆ FDK-083G2118
25	29	26	25	◆ FDK-083G2119
32	35	32	25	◆ FDK-083G2120
40	41	38	40	◆ FDK-083G2121
50	53	50	50	◆ FDK-083G2122
65	70	66	65	◆ FDK-083G2123
80	85	81	80	◆ FDK-083G2124
100	104	100	100	◆ FDK-083G2125

**ISO 2037 (SMS3008)**

Adapter			Sensor
DN (mm)	D <sub>o</sub> (mm)	D <sub>i</sub> (mm)	DN (mm)

10	13	10	10	◆ FDK-083G2116
15	19	16	15	◆ FDK-083G2117
25	25.6	22.6	25	◆ FDK-083G2109
28	28.6	25.6	25	◆ FDK-083G2100
38	38.6	35.6	40	◆ FDK-083G2111
40	40.6	37.6	40	◆ FDK-083G2101
51	51.6	48.6	50	◆ FDK-083G2112
63.5	64.1	60.3	65	◆ FDK-083G2113
76.1	76.7	72.9	80	◆ FDK-083G2114
101.6	102.5	97.6	100	◆ FDK-083G2115
114.3	115.6	110.3	100	◆ FDK-083G2105

**Tri-Weld (BS 4825-1)**

Adapter			Sensor
DN (mm)	D <sub>o</sub> (mm)	D <sub>i</sub> (mm)	DN (mm)

10	12.7	9.4	10	◆ FDK-083G2276
15.9	19.05	15.75	15	◆ FDK-083G2277
25	25.4	22.1	25	◆ FDK-083G2279
38	38.1	34.8	40	◆ FDK-083G2281
51	50.8	47.5	50	◆ FDK-083G2282
63.5 <sup>1)</sup>	63.5	60.2	65	◆ FDK-083G2283
76.1	76.2	72.9	80	◆ FDK-083G2284
102 <sup>1)</sup>	101.6	97.38	100	◆ FDK-083G2285

◆ Short lead time (details in PMD)

D<sub>o</sub>: outer diameterD<sub>i</sub>: inner diameter<sup>1)</sup> For BS 4825-1 see ISO 2037**Clamp-type connection fittings for MAG 1100 F with flat gaskets for 3A**

For sensors with ceramic and PFA liner.

2 pcs. fittings  
2 pcs. clamps (to join flow sensor and fitting)**DIN 32676**

Adapter			Sensor
DN (mm)	D <sub>o</sub> (mm)	D <sub>i</sub> (mm)	DN (mm)

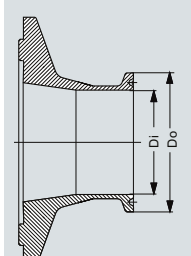

10	34	10	10	◆ FDK-083G2186
15	34	16	15	◆ FDK-083G2187
25	50.5	26	25	◆ FDK-083G2179
40	50.5	38	40	◆ FDK-083G2181
50	64	50	50	◆ FDK-083G2182
65	91	66	65	◆ FDK-083G2183
80	106	81	80	◆ FDK-083G2184
100	119	100	100	◆ FDK-083G2185

**ISO 2852 (SMS 3016, BS 4825-3)**

Adapter			Sensor
DN (mm)	D <sub>o</sub> (mm)	D <sub>i</sub> (mm)	DN (mm)

10	34	10	10	◆ FDK-083G2186
15	34	16	15	◆ FDK-083G2187
25	50.5	26	25	◆ FDK-083G2179
33.7	50.5	31.3	25	◆ FDK-083G2190
38	50.5	35.6	40	◆ FDK-083G2191
51	64	48.6	50	◆ FDK-083G2192
63.5	77.5	60.3	65	◆ FDK-083G2193
76.1	91	72.9	80	◆ FDK-083G2194
101.6	119	97.6	100	◆ FDK-083G2195

**Tri-Clamp**

Adapter			Sensor
DN (mm)	D <sub>o</sub> (mm)	D <sub>i</sub> (mm)	DN (mm)

10	25	10	10	◆ FDK-083G2286
15	25	16	15	◆ FDK-083G2287
25	50.5	22.6	25	◆ FDK-083G2289
38	50.5	35.6	40	◆ FDK-083G2291
51	64	48.6	50	◆ FDK-083G2292
63.5	77.5	60.3	65	◆ FDK-083G2293
76.1	91	72.9	80	◆ FDK-083G2294
101.6	119	97.6	100	◆ FDK-083G2295

◆ Short lead time (details in PMD)

D<sub>o</sub>: outer diameterD<sub>i</sub>: inner diameter

**Threaded type connection fittings for  
MAG 1100 F with flat gaskets for 3A**

For sensors with ceramic and PFA liner.

2 pcs. fittings

2 pcs. clamps (to join flow sensor and fitting)

**DIN 11851**

Adapter			Sensor
DN (mm)	D <sub>o</sub> (mm)	D <sub>i</sub> (mm)	DN (mm)

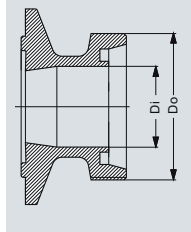

10	28	10	10	<b>FDK-083G2156</b>
15	34	16	15	<b>FDK-083G2157</b>
20	44	20	15	<b>FDK-083G2158</b>
25	52	26	25	◆ <b>FDK-083G2159</b>
32	58	32	25	<b>FDK-083G2160</b>
40	65	38	40	◆ <b>FDK-083G2161</b>
50	78	50	50	◆ <b>FDK-083G2162</b>
65	95	66	65	<b>FDK-083G2163</b>
80	110	81	80	<b>FDK-083G2164</b>
100	130	100	100	<b>FDK-083G2165</b>

**ISO 2853**

Adapter			Sensor
DN (mm)	D <sub>o</sub> (mm)	D <sub>i</sub> (mm)	DN (mm)

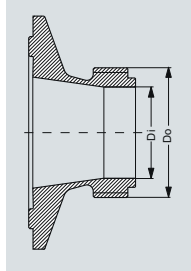

25	37	22.6	25	<b>FDK-083G2149</b>
38	51	35.6	40	<b>FDK-083G2151</b>
51	64	48.6	50	<b>FDK-083G2152</b>
63.5	78	60.3	65	<b>FDK-083G2153</b>
76.1	91	72.9	80	<b>FDK-083G2154</b>
101.6	118	97.6	100	<b>FDK-083G2155</b>

**BS 4825-4**

Adapter			Sensor
DN (mm)	D <sub>o</sub> (mm)	D <sub>i</sub> (mm)	DN (mm)

25	37	22.6	25	<b>FDK-083G2149</b>
38	51	35.6	40	<b>FDK-083G2151</b>
51	64	48.6	50	<b>FDK-083G2152</b>
63.5	78	60.3	65	<b>FDK-083G2153</b>
76.1	91	72.9	80	<b>FDK-083G2154</b>
101.6	126	97.6	100	<b>FDK-083G2145</b>

**Threaded type connection fittings for  
MAG 1100 F with flat gaskets for 3A**

For sensors with ceramic and PFA liner.

2 pcs. fittings

2 pcs. clamps (to join flow sensor and fitting)

**SMS 1145**

Adapter			Sensor
DN (mm)	D <sub>o</sub> (mm)	D <sub>i</sub> (mm)	DN (mm)

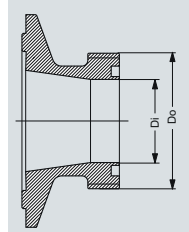

25	40	22.6	25	<b>FDK-083G2139</b>
38	60	35.6	40	<b>FDK-083G2141</b>
51	70	48.6	50	<b>FDK-083G2142</b>
63.5	85	60.3	65	<b>FDK-083G2143</b>
76	98	72	65	<b>FDK-083G2144</b>

◆ Short lead time (details in PMD)

D<sub>o</sub>: outer diameterD<sub>i</sub>: inner diameter

**Gaskets**

(2 pcs., between flow sensor and adapter)

MAG 1100 F (PFA) - P gaskets

Rubber: EPDM (FDA)

- DN 10 ◆ **A5E02055286**
- DN 15 ◆ **A5E02055287**
- DN 25 ◆ **A5E02055290**
- DN 40 ◆ **A5E02055291**
- DN 50 ◆ **A5E02055292**
- DN 65 ◆ **A5E02055293**
- DN 80 ◆ **A5E02055295**
- DN 100 ◆ **A5E02055297**

MAG 1100 F (ceramic) - flat gaskets

Rubber: FKM/FPM (FDA)

- DN 10 ◆ **A5E00915707**
- DN 15 ◆ **A5E00915764**
- DN 25 ◆ **A5E00915771**
- DN 40 ◆ **A5E00915773**
- DN 50 ◆ **A5E00915775**
- DN 65 ◆ **A5E00915780**
- DN 80 ◆ **A5E00915782**
- DN 100 ◆ **A5E00915784**

MAG 1100 F (PFA) - flat gaskets

Rubber: EPDM (FDA)

- DN 10 ◆ **FDK-083G2206**
- DN 15 ◆ **FDK-083G2207**
- DN 25 ◆ **FDK-083G2209**
- DN 40 ◆ **FDK-083G2211**
- DN 50 ◆ **FDK-083G2212**
- DN 65 ◆ **FDK-083G2213**
- DN 80 ◆ **FDK-083G2214**
- DN 100 ◆ **FDK-083G2215**

Rubber: NBR

- DN 10 **FDK-083G2216**
- DN 15 **FDK-083G2217**
- DN 25 **FDK-083G2219**
- DN 40 **FDK-083G2221**
- DN 50 **FDK-083G2222**
- DN 65 **FDK-083G2223**
- DN 80 **FDK-083G2224**
- DN 100 **FDK-083G2225**

◆ Short lead time (details in PMD)