

SIMOTICS XP 1MA Explosion-Proof Motors

Dimensions

Cast-iron series 1MA6
Frame sizes 100 L to 160 L

Dimensional drawings

Type of construction IM B3

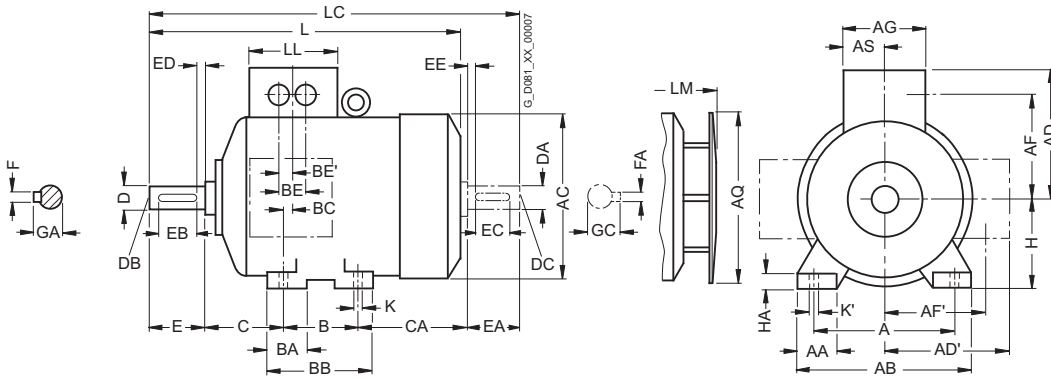

Types of construction IM B5 and IM V1

For flange dimensions, see section flange dimension (Z = the number of retaining holes)

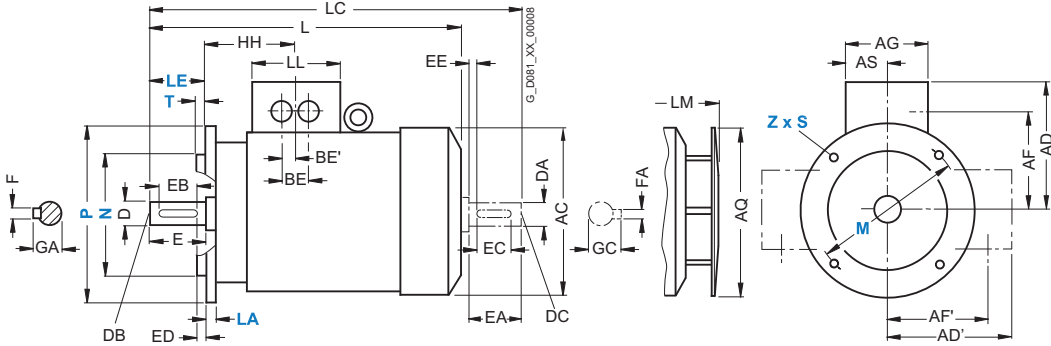

For motor			Dimension designation acc. to IEC																				
Frame size	Type	Number of poles	A	AA	AB	AC ¹⁾	AD	AD'	AF	AF'	AG	AQ	AS	B	BA	BB	BC	BE	BE'	C	CA	H	HA
100 L	1MA6106	2, 4, 6, 8	160	40	196	201	164	164	124	124	121	170	60.5	140	46	180	42	44	22	63	125	100	12
	1MA6107	4, 8																					
112 M	1MA6113	2, 4, 6, 8	190	42.5	226	225.5	178	178	138	138	121	170	60.5	140	46	180	34	44	22	70	141	112	15
132 S	1MA6130	2, 4, 6, 8	216	50	256	265	194	194	154	154	141	250	70.5	140	47	180	42	44	22	89	162.5	132	17
	1MA6131	2																					
132 M	1MA6133	4, 6, 8	216	50	256	265	194	194	154	154	141	250	70.5	178	49	218	42	44	22	89	124.5	132	17
	1MA6134	6																					
160 M	1MA6163	2, 4, 6, 8	254	60	300	320	226	226	183	183	166	250	83	210	63	256	52	54	27	108	183	160	18
	1MA6164	2, 8																					
160 L	1MA6166	2, 4, 6, 8	254	60	300	320	226	226	183	183	166	250	83	254	63	300	52	54	27	108	139	160	18

¹⁾ Measured across the bolt heads.

Dimensional drawings (continued)

Type of construction IM B35

For flange dimensions, see section flange dimension (Z = the number of retaining holes)

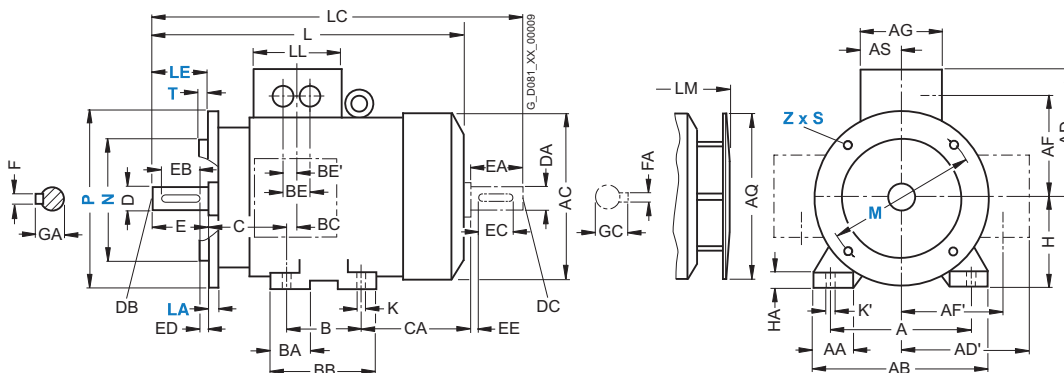

Type of construction IM B14

For flange dimensions, see section flange dimension (Z = the number of retaining holes)

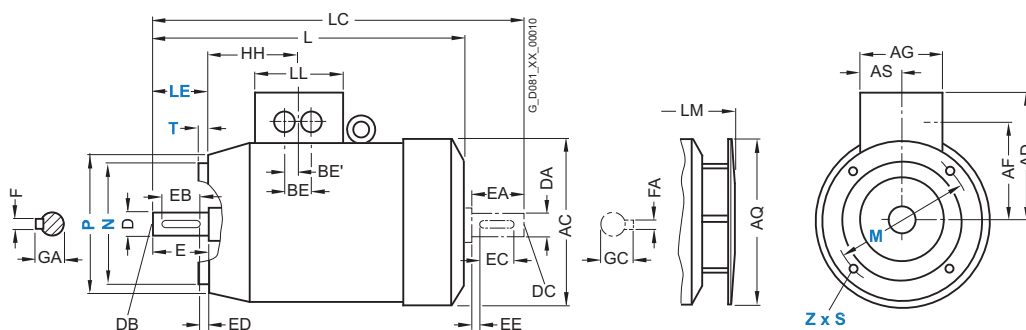

For motor		Number of poles	Dimension designation acc. to IEC										DE shaft extension			NDE shaft extension							
Frame size	Type		HH	K	K'	L	LC	LL	LM	D	DB	E	EB	ED	F	GA	DA	DC	EA	EC	EE	FA	GC
100 L	1MA6106	2, 4, 6, 8	104.5	12	16	372	438	121	423.5	28	M10	60	50	5	8	31	24	M8	50	40	5	8	27
	1MA6107	4, 8																					
112 M	1MA6113	2, 4, 6, 8	104.5	12	16	393	461	121	444.5	28	M10	60	50	5	8	31	24	M8	50	40	5	8	27
132 S	1MA6130	2, 4, 6, 8	130.5	12	16	453.5	551.5	141	506	38	M12	80	70	5	10	41	38	M12	80	70	5	10	41
	1MA6131	2																					
132 M	1MA6133	4, 6, 8	130.5	12	16	453.5	551.5	141	506	38	M12	80	70	5	10	41	38	M12	80	70	5	10	41
	1MA6134	6																					
160 M	1MA6163	2, 4, 6, 8	160	14.5	18	588	721	166	640.5	42	M16	110	90	10	12	45	42	M16	110	90	10	12	45
	1MA6164	2, 8																					
160 L	1MA6166	2, 4, 6, 8	160	14.5	18	588	721	166	640.5	42	M16	110	90	10	12	45	42	M16	110	90	10	12	45