

SIMOTICS SD 1LE1 Standard Motors

Dimensions

Cast-iron series 1LE1523, 1LE1623
Self-ventilated, frame sizes 100 L to 160 L

Dimensional drawings

Type of construction IM B3

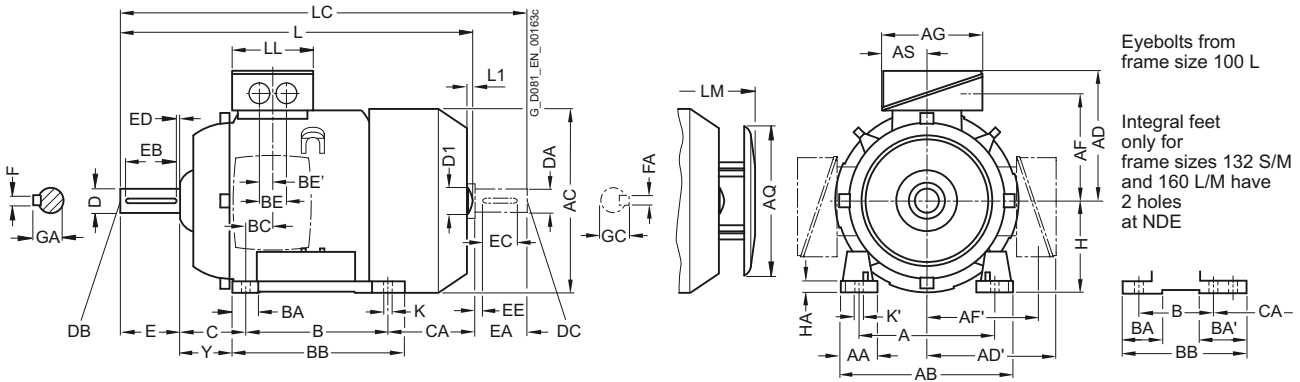

Types of construction IM B5, IM V1

For flange dimensions, see section flange dimension (Z = the number of retaining holes)

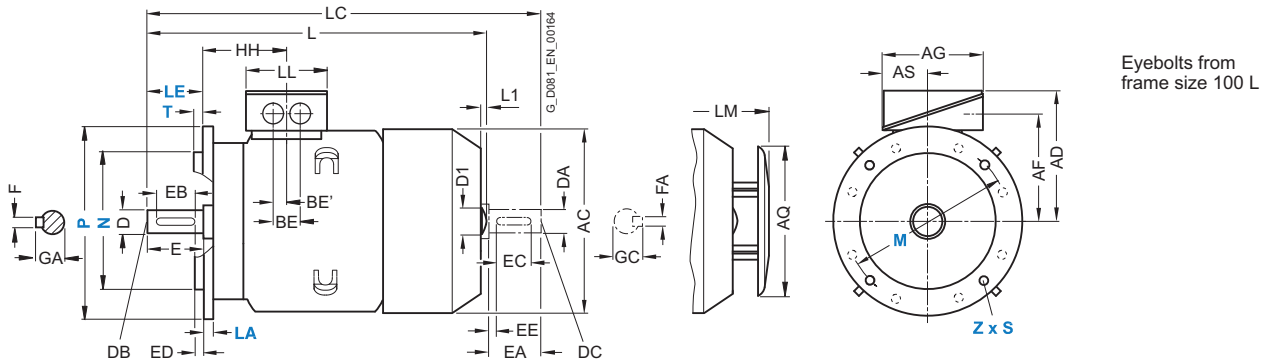

For motor			Dimension designation acc. to IEC																						
Frame size	Number of poles	Motor type	A	AA	AB	AC	AD	AD'	AF	AF'	AG	AQ	AS	B*	BA	BA'	BB	BC	BE	BE'	C ¹⁾	CA*	H	HA	Y ¹⁾
100 L	2, 4	1AA4, 1AB4, 1AB5	160	42	196	198	193	193	147	147	163	195	80.5	140	40	-	176	37.5	48	24	63	176	100	12	45
		1BA2, 1BB2	190	46	226	222	195	195	150	150	163	195	80.5	140	40	-	176	30	48	24	70	155	112	12	52
132 S	2, 4	1CA0, 1CC0	216	53	256	262	214.5	214.5	169	169	163	260	80.5	140	44	81 ²⁾	218 ³⁾	26.5	48	24	89	128.5	132	15	69
		1CA1, 1CB0														-						178.5			
132 M	6, 4, 6, 8	1CC2	216	53	256	262	214.5	214.5	169	169	163	260	80.5	178	44	81 ²⁾	218	26.5	48	24	89	128.5	132	15	69
		1CB2, 1CC3														-						178.5			
160 M	2, 4, 6	1DA2, 1DA3, 1DB2, 1DC2	254	60	300	314	261	261	213	213	190	260	92	210	51	95 ⁴⁾	300 ⁵⁾	37	60	30	108	148	160	18	85
		1DA4, 1DB4, 1DC4	254	60	300	314	261	261	213	213	190	260	92	254	51	95 ⁴⁾	300	37	60	30	108	208	160	18	85

* This dimension is assigned in DIN EN 50347 to the frame size listed.

¹⁾ Additional information – not a standard dimension according to DIN EN 50347.

²⁾ With screwed-on feet, dimension BA' is 43 mm.

³⁾ With screwed-on feet, dimension BB is 180 mm.

⁴⁾ With screwed-on feet, dimension BA' is 51 mm.

⁵⁾ With screwed-on feet, dimension BB is 256 mm.

Dimensional drawings (continued)

Type of construction IM B35

For flange dimensions, see section flange dimension (Z = the number of retaining holes)

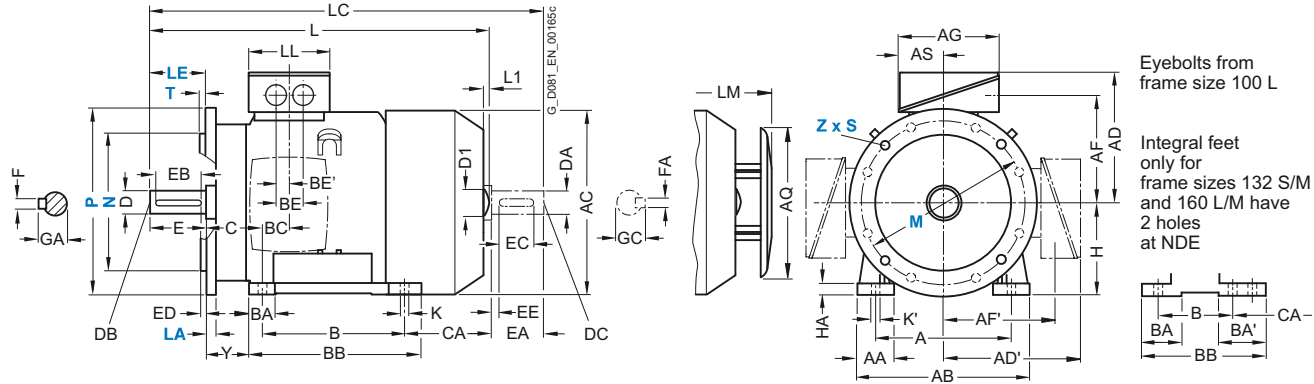

Type of construction IM B14

For flange dimensions, see section flange dimension (Z = the number of retaining holes)

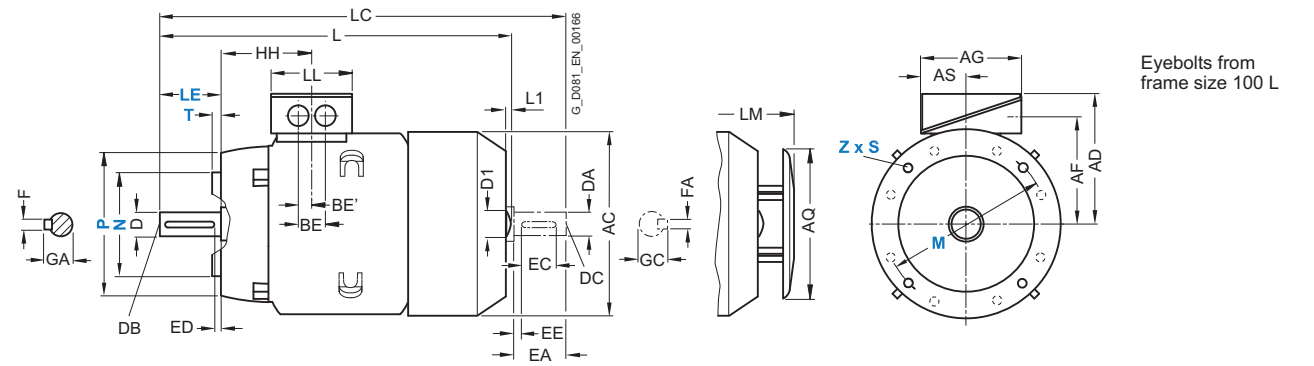

For motor			Dimension designation acc. to IEC							DE shaft extension					NDE shaft extension										
Frame size	Number of poles	Motor type	HH	K	K'	L ¹⁾	L ¹⁾²⁾	D1	LC	LL	LM	D	DB	E	EB	ED	F	GA	DA	DC	EA	EC	EE	FA	GC
100 L	2, 4	1AA4, 1AB4, 1AB5	100.5	12	16	425	7	32	489	134	463.5	28	M10	60	50	5	8	31	24	M8	50	40	5	8	27
112 M	2, 4	1BA2, 1BB2	100.5	12	16	408.5	7	32	475	134	447	28	M10	60	50	5	8	31	24	M8	50	40	5	8	27
132 S	2, 6	1CA0, 1CC0	115.5	12	16	458	8.5	39	535.5	134	516.5	38	M12	80	70	5	10	41	28	M10	60	50	5	8	31
	2, 4	1CA1, 1CB0				508			585.5		566.5														
132 M	6	1CC2	115.5	12	16	458	8.5	39	535.5	134	516.5	38	M12	80	70	5	10	41	28	M10	60	50	5	8	31
	4, 6	1CB2, 1CC3				508			585.5		566.5														
160 M	2, 4, 6	1DA2, 1DA3, 1DB2, 1DC2	145	15	19	596	10	45	730	165	654	42	M16	110	90	10	12	45	42	M16	110	90	10	12	45
160 L	2, 4, 6	1DA4, 1DB4, 1DC4	145	15	19	656	10	45	790	165	714	42	M16	110	90	10	12	45	42	M16	110	90	10	12	45

¹⁾ For 1LE15 motors, plus dimension L1.

²⁾ Only for 1LE15 motors.