

SIMOTICS SD 1LE1 Standard Motors

Dimensions

Cast-iron series 1LE1501, 1LE1521, 1LE1601, 1LE1621

Self-ventilated, frame sizes 100 L to 160 L

Dimensional drawings

Type of construction IM B3

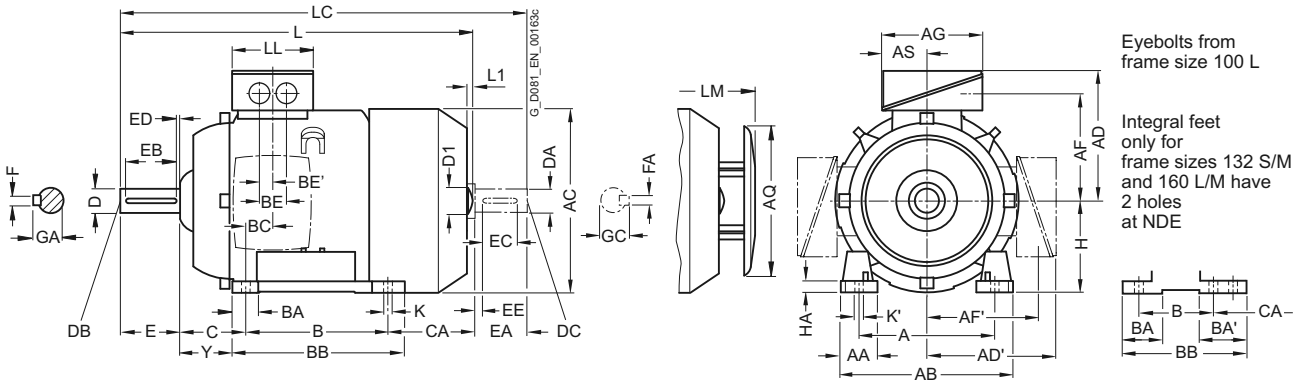

Types of construction IM B5, IM V1

For flange dimensions, see section flange dimension (Z = the number of retaining holes)

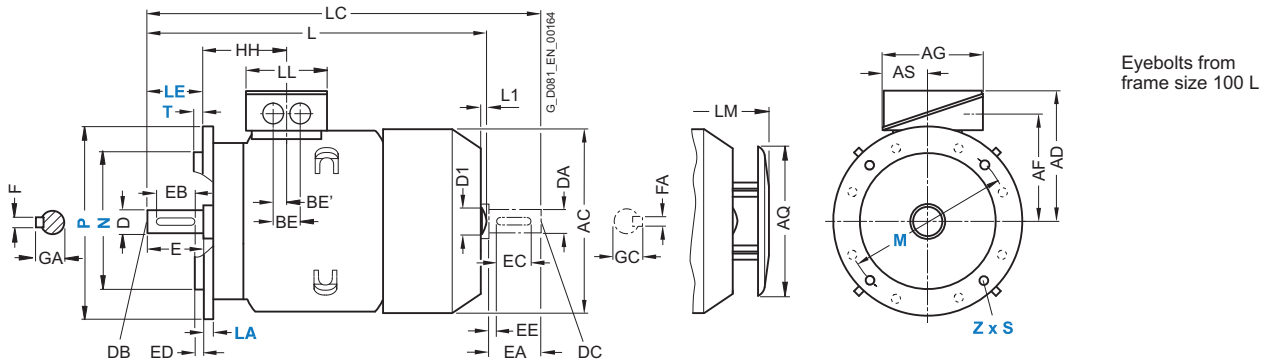

For motor		Dimension designation acc. to IEC																						
Frame size	Number of poles	A	AA	AB	AC	AD	AD'	AF	AF'	AG	AQ	AS	B*	BA	BA'	BB	BC	BE	BE'	C ¹⁾	CA*	H	HA	Y ¹⁾
100 L	2, 4, 6, 8	160	42	196	198	193	193	147	147	163	195	80.5	140	40	-	176	37.5	48	24	63	141	100	12	45
112 M	2, 4, 6, 8	190	46	226	222	195	195	150	150	163	195	80.5	140	40	-	176	30	48	24	70	129.7	112	12	52
132 S	2, 4, 6, 8	216	53	256	262	214.5	214.5	169	169	163	260	80.5	140	44	81 ²⁾	218 ⁴⁾	26.5	48	24	89	-	132	15	69
132 M	2, 4, 6, 8	216	53	256	262	214.5	214.5	169	169	163	260	80.5	178	44	81 ²⁾	218	26.5	48	24	89	-	132	15	69
160 M	2, 4, 6, 8	254	60	300	314	261	261	213	213	190	260	92	210	51	95 ³⁾	300 ⁵⁾	37	60	30	108	-	160	18	85
160 L	2, 4, 6, 8	254	60	300	314	261	261	213	213	190	260	92	254	51	95 ³⁾	300	37	60	30	108	-	160	18	85

* This dimension is assigned in DIN EN 50347 to the frame size listed.

1) Additional information – not a standard dimension according to DIN EN 50347.

2) With screwed-on feet, dimension BA' is 43 mm.

3) With screwed-on feet, dimension BA' is 51 mm.

4) With screwed-on feet, dimension BB is 180 mm.

5) With screwed-on feet, dimension BB is 256 mm.

