

# Servomotors

## Dimensional drawings

### 1FT7 Compact motors with/without DRIVE-CLiQ with SP+ planetary gearbox, single-stage

#### Dimensional drawings

For motors		Dimensions in mm (inches)										Encoder system:	
Shaft height	Type	F4	Planetary gearbox Type	D1	D2	D3	D4	L5	L6	L7	L8	Incremental encoder	Absolute encoder
												without brake	with brake
1FT7 Compact with SP+ planetary gearbox, single-stage, type of construction IM B5, natural cooling, with connector, with/without brake													
36	1FT7034	62 (2.44)	SP060S-MF1	60 (2.36)	16 (0.63)	5.5 (0.22)	68 (2.68)	142 (5.59)	28 (1.10)	20 (0.79)	6 (0.24)	347 (13.66)	374 (14.72)
	1FT7034	76 (2.99)	SP075S-MF1	70 (2.76)	22 (0.87)	6.6 (0.26)	85 (3.35)	163.8 (6.45)	36 (1.42)	20 (0.79)	7 (0.28)	361 (14.21)	388 (15.28)
	1FT7036												297 (11.69)
48	1FT7042							167.5 (6.59)				275 (10.83)	307 (12.09)
	1FT7044											325 (12.80)	357 (14.06)
	1FT7046											365 (14.37)	397 (15.63)
	1FT7046	101 (3.98)	SP100S-MF1	90 (3.54)	32 (1.26)	9 (0.35)	120 (4.72)	210 (8.27)	58 (2.28)	30 (1.18)	10 (0.39)	375 (14.76)	407 (16.02)
63	1FT7062							217 (8.54)				296 (11.65)	331 (13.03)
	1FT7064											327 (12.87)	362 (14.25)
	1FT7066											359 (14.13)	394 (15.51)
	1FT7068											406 (15.98)	441 (17.36)
	1FT7068	141 (5.55)	SP140S-MF1	130 (5.12)	40 (1.57)	11 (0.43)	165 (6.50)	274.3 (10.80)	82 (3.23)	30 (1.18)	12 (0.47)	439 (17.28)	474 (18.66)
80	1FT7082							283.3 (11.15)				361 (14.21)	413 (16.26)
	1FT7084											412 (16.22)	464 (18.27)
	1FT7086											464 (18.27)	516 (20.31)
	1FT7086	182 (7.17)	SP180S-MF1	160 (6.30)	55 (2.17)	13.5 (0.53)	215 (8.46)	310 (12.20)	82 (3.23)	30 (1.18)	15 (0.59)	491 (19.33)	543 (21.38)
100	1FT7102											412 (16.22)	464 (18.27)
	1FT7105											498 (19.61)	550 (21.65)
	1FT7108											568 (22.36)	620 (24.41)
	1FT7105	215 (8.46)	SP210S-MF1	180 (7.09)	75 (2.95)	17 (0.67)	250 (9.84)	385 (15.16)	105 (4.13)	38 (1.50)	17 (0.67)	542 (21.34)	594 (23.39)
	1FT7108											612 (24.09)	664 (26.14)

1FT703  
1FT704  
1FT706  
1FT708  
1FT710

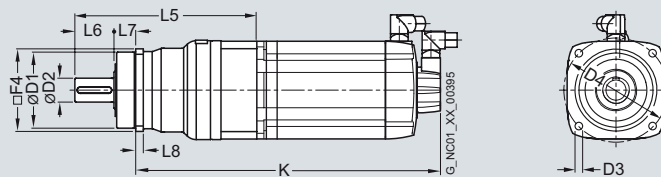

# Servomotors

## Dimensional drawings

### 1FT7 Compact motors with/without DRIVE-CLiQ with SP+ planetary gearbox, 2-stage

#### Dimensional drawings

For motor		Dimensions in mm (inches)										Encoder system:	
Shaft height	Type	F4	Planetary gearbox Type	D1	D2	D3	D4	L5	L6	L7	L8	Incremental encoder	Absolute encoder
												without brake	with brake
1FT7 Compact with SP+ planetary gearbox, 2-stage, type of construction IM B5, natural cooling, with connector, with/without brake													
36	1FT7034	76 (2.99)	SP075S-MF2	70 (2.76)	22 (0.87)	6.6 (0.26)	85 (3.35)	179.4 (7.06)	36 (1.42)	20 (0.79)	7 (0.28)	376 (14.80)	403 (15.87)
	1FT7036											312 (12.28)	339 (13.35)
48	1FT7042							192 (7.56)				331 (13.03)	331 (13.03)
36	1FT7034	101 (3.98)	SP100S-MF2	90 (3.54)	32 (1.26)	9 (0.35)	120 (4.72)	230.3 (9.07)	58 (2.28)	30 (1.18)	10 (0.39)	395 (15.55)	422 (16.61)
	1FT7036											331 (13.03)	358 (14.09)
48	1FT7042							234 (9.21)				341 (13.43)	341 (13.43)
	1FT7044											359 (14.13)	391 (15.39)
	1FT7046											431 (16.97)	431 (16.97)
	1FT7044	141 (5.55)	SP140S-MF2	130 (5.12)	40 (1.58)	11 (0.43)	165 (6.50)	298.3 (11.74)	82 (3.23)	30 (1.18)	12 (0.47)	399 (15.71)	431 (16.97)
1FT7046	471 (18.54)											471 (18.54)	

1FT703  
1FT704

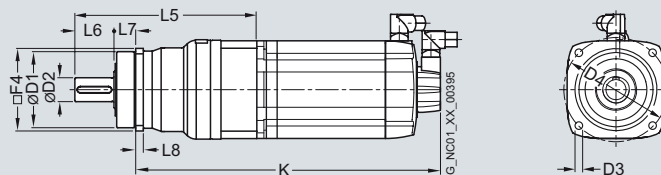

# Servomotors

## Dimensional drawings

### 1FT7 Compact motors with/without DRIVE-CLiQ with SP+ planetary gearbox, 2-stage

#### Dimensional drawings

For motor		Dimensions in mm (inches)										Encoder system:	
Shaft height	Type	F4	Planetary gearbox Type	D1	D2	D3	D4	L5	L6	L7	L8	Incremental encoder	Absolute encoder
												without brake K	with brake K
<b>1FT7 Compact with SP+ planetary gearbox, 2-stage, type of construction IM B5, natural cooling, with connector, with/without brake</b>													
63	1FT7062	101 (3.98)	SP100S-MF2	90 (3.54)	32 (1.26)	9 (0.35)	120 (4.72)	252 (9.92)	58 (2.28)	30 (1.18)	10 (0.39)	331 (13.03)	366 (14.41)
	1FT7064											362 (14.25)	397 (15.63)
	1FT7062	141 (5.55)	SP140S-MF2	130 (5.12)	40 (1.57)	11 (0.43)	165 (6.50)	305 (12.01)	82 (3.23)	30 (1.18)	12 (0.47)	360 (14.17)	395 (15.55)
	1FT7064											391 (15.39)	426 (16.77)
	1FT7066											458 (18.03)	458 (18.03)
	1FT7068											505 (19.88)	505 (19.88)
80	1FT7082							332 (13.07)				410 (16.14)	462 (18.19)
	1FT7084											461 (18.15)	513 (20.20)
63	1FT7064	182 (7.17)	SP180S-MF2	160 (6.30)	55 (2.17)	13.5 (0.53)	215 (8.46)	346 (13.62)	82 (3.23)	30 (1.18)	15 (0.59)	432 (17.01)	467 (18.39)
	1FT7066											499 (19.65)	499 (19.65)
	1FT7068											546 (21.50)	546 (21.50)
	1FT7082							355 (13.98)				433 (17.05)	485 (19.09)
	1FT7084											536 (21.10)	536 (21.10)
	1FT7086											536 (21.10)	588 (23.15)
100	1FT7102											457 (17.99)	509 (20.04)
80	1FT7084	215 (8.46)	SP210S-MF2	180 (7.09)	75 (2.95)	17 (0.67)	250 (9.84)	415 (16.34)	105 (4.13)	38 (1.50)	17 (0.67)	565 (22.24)	565 (22.24)
	1FT7086											617 (24.29)	617 (24.29)
100	1FT7102											538 (21.18)	538 (21.18)
	1FT7105											572 (22.52)	624 (24.57)
	1FT7108											694 (27.32)	694 (27.32)
	1FT7086	245 (9.65)	SP240S-MF2	200 (7.87)	85 (3.35)	17 (0.67)	290 (11.42)	467.5 (18.41)	130 (5.12)	40 (1.57)	20 (0.79)	643 (25.31)	643 (25.31)
100	1FT7102											512 (20.16)	564 (22.20)
	1FT7105											598 (23.54)	650 (25.59)
	1FT7108											668 (26.30)	720 (28.35)

1FT706  
1FT708  
1FT710

