

Servomotors

Dimensional drawings

1FK7 Compact motors with/without DRIVE-CLiQ with LP+ planetary gearbox, single-stage

Dimensional drawings

For motor			Dimensions in mm (inches)												
Shaft height	Type	Planetary gearbox Type													
			D ₁	D ₂	D ₃	D ₄	D ₅	L ₂	L ₃	L ₄	L ₅	L ₈	L ₉	L ₁₀	L ₁₆
1FK7 Compact with LP+ planetary gearbox, single-stage, type of construction IM B5, natural cooling, with connector, with/without brake															
28	1FK7022-5	LP050-MO1	50 (1.97)	35 (1.38)	12 (0.47)	44 (1.73)	M4	18 (0.71)	4 (0.16)	7 (0.28)	8 (0.31)	14 (0.55)	4 (0.16)	50 (1.97)	88 (3.46)
	1FK7022-5	LP070-MO1	70 (2.76)	52 (2.05)	16 (0.63)	62 (2.44)	M5	28 (1.10)	5 (0.20)	8 (0.31)	10 (0.39)	18 (0.71)	5 (0.20)	70 (2.76)	119 (4.69)
36	1FK7032-5	LP070-MO1	70 (2.76)	52 (2.05)	16 (0.63)	62 (2.44)	M5	28 (1.10)	5 (0.20)	8 (0.31)	10 (0.39)	18 (0.71)	5 (0.20)	70 (2.76)	126 (4.96)
	1FK7034-5														
48	1FK7040-5	LP090-MO1	90 (3.54)	68 (2.68)	22 (0.87)	80 (3.15)	M6	36 (1.42)	5 (0.20)	10 (0.39)	12 (0.47)	25 (0.98)	6 (0.24)	90 (3.54)	158 (6.22)
	1FK7042-5														
63	1FK7060-5	LP120-MO1	120 (4.72)	90 (3.54)	32 (1.26)	108 (4.25)	M8	58 (2.28)	6 (0.24)	12 (0.47)	16 (0.63)	35 (1.38)	10 (0.39)	120 (4.72)	210 (8.27)
	1FK7063-5														
80	1FK7080-5	LP155-MO1	155 (6.10)	120 (4.72)	40 (1.57)	140 (5.51)	M10	82 (3.23)	8 (0.31)	15 (0.59)	20 (0.79)	43 (1.69)	12 (0.47)	150 (5.91)	266 (10.47)
	1FK7083-5														

Shaft height	Type	DIN IEC	Encoder system:				Incremental encoder IC2048S/R / IC22DQ				l E	d D	a ₁ P
			Resolver		Absolute encoder AM16S/R AM15DQ		Absolute encoder AM2048S/R / AM22DQ		Absolute encoder AM512S/R / AM20DQ AM32S/R / AM16DQ				
			without brake	with brake	without brake	with brake	without brake	with brake					
k LB	K -	k LB	K -	k LB	K -	k LB	K -						
28	1FK7022-5		153 (6.02)	216 (8.50)	175 (6.89)	238 (9.37)	178 (7.01)	241 (9.49)	200 (7.87)	263 (10.35)	20 (0.79)	9 (0.35)	-
	1FK7022-5			236 (9.29)		258 (10.16)		261 (10.28)		283 (11.14)			
36	1FK7032-5		150 (5.91)	240 (9.45)	175 (6.89)	265 (10.43)	175 (6.89)	265 (10.43)	200 (7.87)	290 (11.42)	30 (1.18)	14 (0.55)	92 (3.62)
	1FK7034-5		175 (6.89)	265 (10.43)	200 (7.87)	290 (11.42)	200 (7.87)	290 (11.42)	225 (8.86)	315 (12.40)			
48	1FK7040-5		135 (5.31)	247 (9.72)	164 (6.46)	276 (10.87)	155 (6.10)	267 (10.51)	184 (7.24)	296 (11.65)	40 (1.57)	19 (0.75)	120 (4.72)
	1FK7042-5		162 (6.38)	274 (10.79)	191 (7.52)	303 (11.93)	183 (7.20)	295 (11.61)	212 (8.35)	324 (12.76)			
63	1FK7060-5		157 (6.18)	297 (11.69)	200 (7.87)	340 (13.39)	180 (7.09)	320 (12.60)	223 (8.78)	363 (14.29)	50 (1.97)	24 (0.94)	155 (6.10)
	1FK7063-5		202 (7.95)	342 (13.46)	245 (9.65)	385 (15.16)	225 (8.86)	365 (14.37)	268 (10.55)	408 (16.06)			
80	1FK7080-5		156 (6.14)	325 (12.80)	184 (7.24)	353 (13.90)	179 (7.05)	347 (13.66)	206 (8.11)	375 (14.76)	58 (2.28)	32 (1.26)	186 (7.32)
	1FK7083-5		194 (7.64)	363 (14.29)	245 (9.65)	414 (16.30)	217 (8.54)	385 (15.16)	268 (10.55)	436 (17.17)			

1FK702.-5
1FK703.-5
1FK704.-5
1FK706.-5
1FK708.-5

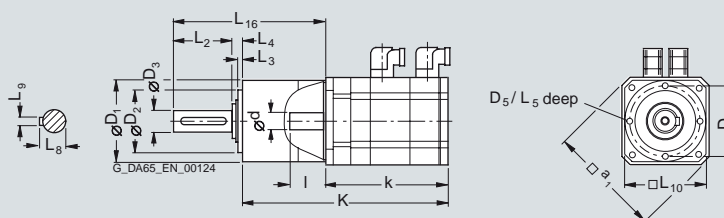

Servomotors Dimensional drawings

1FK7 Compact motors with/without DRIVE-CLiQ with LP+ planetary gearbox, single-stage

Dimensional drawings

For motor		Dimensions in mm (inches)													
Shaft height	Type	Planetary gearbox Type	D ₁	D ₂	D ₃	D ₄	D ₅	L ₂	L ₃	L ₄	L ₅	L ₈	L ₉	L ₁₀	L ₁₆
			1FK7 Compact with LP+ planetary gearbox, single-stage, type of construction IM B5, natural cooling, with connector, with/without brake												
100	1FK710-5	LP155-MO1	155 (6.10)	120 (4.72)	40 (1.57)	140 (5.51)	M10	82 (3.23)	8 (0.31)	15 (0.59)	20 (0.79)	43 (1.69)	12 (0.47)	150 (5.91)	286 (11.26)

Shaft height	Type	DIN IEC	Encoder system:								l E	d D	a ₁ P
			Resolver				Incremental encoder Absolute encoder						
			without brake		with brake		without brake		with brake				
k LB	K -	k LB	K -	k LB	K -	k LB	K -	K -					
100	1FK7100-5		185 (7.28)	374 (14.72)	204 (8.03)	393 (15.47)	208 (8.19)	396 (15.59)	227 (8.94)	415 (16.34)	80 (3.15)	38 (1.50)	240 (9.45)
	1FK7101-5		211 (8.31)	400 (15.75)	240 (9.45)	429 (16.89)	234 (9.21)	422 (16.61)	263 (10.35)	452 (17.80)			
	1FK7103-5		237 (9.33)	426 (16.77)	266 (10.47)	455 (17.91)	260 (10.24)	448 (17.64)	289 (11.38)	478 (18.82)			
	1FK7105-5		289 (11.38)	478 (18.82)	318 (12.52)	507 (19.96)	312 (12.28)	500 (19.69)	341 (13.43)	530 (20.87)			

1FK710-5

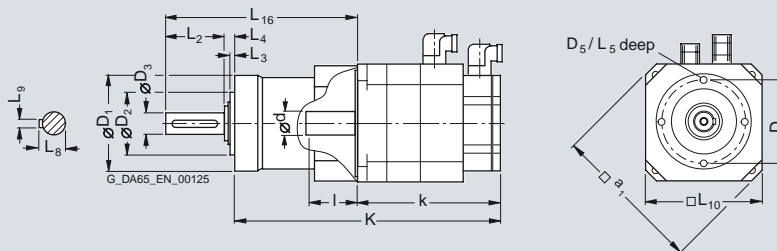

Servomotors

Dimensional drawings

1FK7 High Dynamic motors with/without DRIVE-CLiQ with LP+ planetary gearbox, single-stage

Dimensional drawings

For motor			Dimensions in mm (inches)												
Shaft height	Type	Planetary gearbox	D ₁	D ₂	D ₃	D ₄	D ₅	L ₂	L ₃	L ₄	L ₅	L ₈	L ₉	L ₁₀	L ₁₆
			1FK7 High Dynamic with LP+ planetary gearbox, single-stage, type of construction IM B5, natural cooling, with connector, with/without brake												
36	1FK7033-7	LP070-MO1	70 (2.76)	52 (2.05)	16 (0.63)	62 (2.44)	M5	28 (1.10)	5 (0.20)	8 (0.31)	10 (0.39)	18 (0.71)	5 (0.20)	70 (2.76)	126 (4.96)
48	1FK7043-7 1FK7044-7	LP090-MO1	90 (3.54)	68 (2.68)	22 (0.87)	80 (3.15)	M6	36 (1.42)	5 (0.20)	10 (0.39)	12 (0.47)	25 (0.98)	6 (0.24)	90 (3.54)	158 (6.22)
63	1FK7061-7 1FK7064-7	LP120-MO1	120 (4.72)	90 (3.54)	32 (1.26)	108 (4.25)	M8	58 (2.28)	6 (0.24)	12 (0.47)	16 (0.63)	35 (1.38)	10 (0.39)	120 (4.72)	210 (8.27)
80	1FK7085-7 1FK7086-7	LP155-MO1	155 (6.10)	120 (4.72)	40 (1.57)	140 (5.51)	M10	82 (3.23)	8 (0.31)	15 (0.59)	20 (0.79)	43 (1.69)	12 (0.47)	150 (5.91)	266 (10.47)

Shaft height	Type	DIN IEC	Encoder system:		Incremental encoder		Absolute encoder		I E	d D	a ₁ P		
			Resolver	Absolute encoder	without brake	with brake	without brake	with brake					
			AM16S/R AM15DQ	AM16S/R AM15DQ	k LB	K -	k LB	K -				k LB	K -
36	1FK7033-7		170 (6.69)	260 (10.24)	195 (7.68)	285 (11.22)	195 (7.68)	285 (11.22)	220 (8.66)	310 (12.20)	30 (1.18)	14 (0.55)	92 (3.62)
48	1FK7043-7 1FK7044-7		191 (7.52)	303 (11.93)	220 (8.66)	332 (13.07)	212 (8.35)	324 (12.76)	240 (9.45)	352 (13.86)	40 (1.57)	19 (0.75)	120 (4.72)
63	1FK7061-7 1FK7064-7		185 (7.28)	325 (12.80)	228 (8.98)	368 (14.49)	208 (8.19)	348 (13.70)	251 (9.88)	391 (15.39)	50 (1.97)	24 (0.94)	155 (6.10)
80	1FK7085-7 1FK7086-7		261 (10.28)	430 (16.93)	304 (11.97)	473 (18.62)	284 (11.18)	453 (17.83)	326 (12.83)	495 (19.49)	58 (2.28)	32 (1.26)	186 (7.32)

1FK7033-7
1FK704-7
1FK706-7
1FK708-7

