

Servomotors

Dimensional drawings

1FK7 Compact motors with/without DRIVE-CLiQ Natural cooling

Dimensional drawings

For motor Dimensions in mm (inches)

Shaft height	Type	DIN IEC	a ₁ P	b ₁ N	c ₁ LA	e ₁ M	f AB	f ₁ T	g ₂ -	h H	i ₂ -	s ₂ S	Encoder system:					
													Resolver Absolute encoder AM16S/R / AM15DQ					
													without brake			with brake		
													k LB	o ₁ -	o ₂ -	k LB	o ₁ -	o ₂ -
1FK7 Compact, type of construction IM B5, natural cooling, with connector, with/without brake																		
20	1FK7011-5		-	30 (1.18)	7 (0.28)	46 (1.81)	40 (1.57)	2.5 (0.10)	65.5 (2.58)	20 (0.79)	18 (0.71)	4.5 (0.18)	140 (5.51)	89 (3.50)	118 (4.65)	140 (5.51)	89 (3.50)	118 (4.65)
	1FK7015-5												165 (6.50)	114 (4.49)	143 (5.63)	165 (6.50)	114 (4.49)	143 (5.63)
28	1FK7022-5		-	40 (1.57)	10 (0.39)	63 (2.48)	55 (2.17)	2.5 (0.10)	75 (2.95)	27.5 (1.08)	20 (0.79)	5.4 (0.21)	153 (6.02)	95 (3.74)	128 (5.04)	175 (6.89)	95 (3.74)	150 (5.91)
	1FK7032-5		92 (3.62)	60 (2.36)	8 (0.31)	75 (2.95)	72 (2.83)	3 (0.12)	81 (3.19)	36 (1.42)	30 (1.18)	6.5 (0.26)	150 (5.91)	90 (3.54)	125 (4.92)	175 (6.89)	90 (3.54)	149 (5.87)
36	1FK7034-5												175 (6.89)	115 (4.53)	150 (5.91)	200 (7.87)	115 (4.53)	174 (6.85)
	1FK7040-5		120 (4.72)	80 (3.15)	10 (0.39)	100 (3.94)	96 (3.78)	3 (0.12)	90 (3.54)	48 (1.89)	40 (1.57)	7 (0.28)	134 (5.28)	73 (2.87)	106 (4.17)	163 (6.42)	73 (2.87)	135 (5.31)
48	1FK7042-5												162 (6.38)	101 (3.98)	134 (5.28)	191 (7.52)	101 (3.98)	163 (6.42)
	1FK7060-5		155 (6.10)	110 (4.33)	10 (0.39)	130 (5.12)	126 (4.96)	3.5 (0.14)	105 (4.13)	63 (2.48)	50 (1.97)	9 (0.35)	157 (6.18)	94 (3.70)	126 (4.96)	200 (7.87)	94 (3.70)	169 (6.65)
63	1FK7063-5												202 (7.95)	139 (5.47)	171 (6.73)	245 (9.65)	139 (5.47)	214 (8.43)

Shaft height	Type	Encoder system:						Shaft extension DE														
		Incremental encoder IC2048S/R / IC22DQ Absolute encoder AM2048S/R / AM22DQ AM512S/R / AM20DQ AM32S/R / AM16DQ																				
												without brake			with brake							
												k LB	o ₁ -	o ₂ -	k LB	o ₁ -	o ₂ -	d D	d ₆ -	l E	t GA	u F
20	1FK7011-5	155 (6.10)	89 (3.50)	118 (4.65)	155 (6.10)	89 (3.50)	118 (4.65)	8 (0.31)	-	18 (0.71)	8.8 (0.35)	2 (0.08)										
	1FK7015-5	180 (7.09)	114 (4.49)	143 (5.63)	180 (7.09)	114 (4.49)	143 (5.63)															
28	1FK7022-5	178 (7.01)	95 (3.74)	128 (5.04)	200 (7.87)	95 (3.74)	150 (5.91)	9 (0.35)	M3	20 (0.79)	10.2 (0.40)	3 (0.12)										
	1FK7032-5	175 (6.89)	90 (3.54)	125 (4.92)	200 (7.87)	90 (3.54)	149 (5.87)	14 (0.55)	M5	30 (1.18)	16 (0.63)	5 (0.20)										
36	1FK7034-5	200 (7.87)	115 (4.53)	150 (5.91)	225 (8.86)	115 (4.53)	174 (6.85)															
	1FK7040-5	155 (6.10)	73 (2.87)	106 (4.17)	184 (7.24)	73 (2.87)	135 (5.31)	19 (0.75)	M6	40 (1.57)	21.5 (0.85)	6 (0.24)										
48	1FK7042-5	182 (7.17)	101 (3.98)	134 (5.28)	211 (8.31)	101 (3.98)	163 (6.42)															
	1FK7060-5	180 (7.09)	94 (3.70)	126 (4.96)	223 (8.78)	94 (3.70)	169 (6.65)	24 (0.94)	M8	50 (1.97)	27 (1.06)	8 (0.31)										
63	1FK7063-5	225 (8.86)	139 (5.47)	171 (6.73)	268 (10.55)	139 (5.47)	214 (8.43)															

1FK701.-5
1FK702.-5
1FK703.-5
1FK704.-5
1FK706.-5

Shaft design
with fitted key

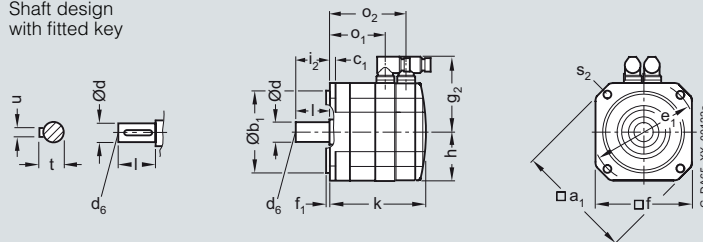

1FK7 Compact motors with/without DRIVE-CLiQ Natural cooling

Dimensional drawings

For motor		Dimensions in mm (inches)											Encoder system: Resolver					
Shaft height	Type	DIN IEC	a ₁ P	b ₁ N	c ₁ LA	e ₁ M	f AB	f ₁ T	g ₂ -	h H	i ₂ -	s ₂ S	without brake			with brake		
													k LB	o ₁ -	o ₂ -	k LB	o ₁ -	o ₂ -
1FK7 Compact, type of construction IM B5, natural cooling, with connector, with/without brake																		
80	1FK7080-5		186 (7.32)	130 (5.12)	13 (0.51)	165 (6.50)	155 (6.10)	3.5 (0.14)	119.5 (4.70)	77.5 (3.05)	58 (2.28)	11 (0.43)	156 (6.14)	91 (3.58)	124 (4.88)	184 (7.24)	91 (3.58)	151 (5.94)
	1FK7083-5												194 (7.64)	129 (5.08)	162 (6.38)	245 (9.65)	129 (5.08)	207 (8.15)
100	1FK7100-5		240 (9.45)	180 (7.09)	13 (0.51)	215 (8.46)	192 (7.56)	4 (0.16)	138 (5.43)	96 (3.78)	80 (3.15)	14 (0.55)	185 (7.28)	113 (4.45)	153 (6.02)	204 (8.03)	113 (4.45)	172 (6.77)
	1FK7101-5												211 (8.31)	139 (5.47)	179 (7.05)	240 (9.45)	139 (5.47)	208 (8.19)
	1FK7103-5												237 (9.33)	165 (6.50)	205 (8.07)	266 (10.47)	165 (6.50)	234 (9.21)
	1FK7105-5												289 (11.38)	217 (8.54)	257 (10.12)	318 (12.52)	217 (8.54)	286 (11.26)

Shaft height	Type	Encoder system: Incremental encoder IC2048S/R / IC22DQ Absolute encoder AM2048S/R / AM22DQ AM32S/R / AM16DQ						Shaft extension DE				
		without brake			with brake			d D	d ₆ -	l E	t GA	u F
		k LB	o ₁ -	o ₂ -	k LB	o ₁ -	o ₂ -					
80	1FK7080-5	179 (7.05)	91 (3.58)	124 (4.88)	206 (8.11)	91 (3.58)	151 (5.94)	32 (1.26)	M12	58 (2.28)	35 (1.38)	10 (0.39)
	1FK7083-5	217 (8.54)	129 (5.08)	162 (6.38)	268 (10.55)	153 (6.02)	213 (8.39)					
100	1FK7100-5	208 (8.19)	113 (4.45)	153 (6.02)	227 (8.94)	113 (4.45)	172 (6.77)	38 (1.50)	M12	80 (3.15)	41 (1.61)	10 (0.39)
	1FK7101-5	234 (9.21)	139 (5.47)	179 (7.05)	263 (10.35)	139 (5.47)	208 (8.19)					
	1FK7103-5	260 (10.24)	165 (6.50)	205 (8.07)	289 (11.38)	165 (6.50)	234 (9.21)					
	1FK7105-5	312 (12.28)	217 (8.54)	257 (10.12)	341 (13.43)	217 (8.54)	286 (11.26)					

1FK708.-5

Shaft design with fitted key

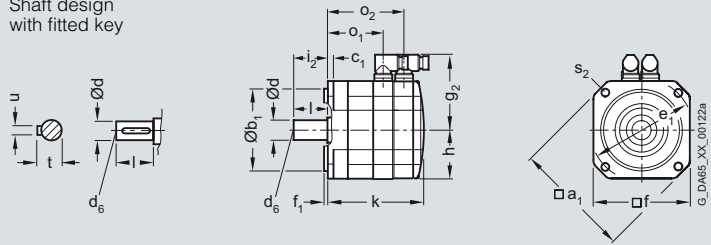

1FK7100-5
1FK7101-5
1FK7103-5
1FK7105-5

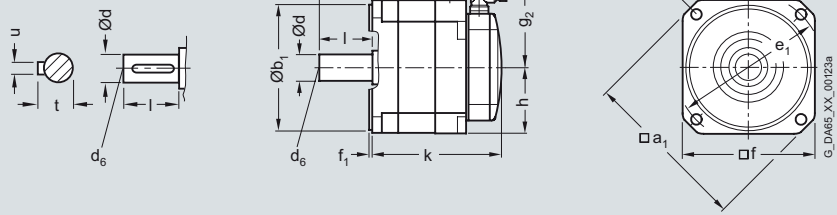

Servomotors

Dimensional drawings

1FK7 High Dynamic motors with/without DRIVE-CLiQ – Natural cooling

Dimensional drawings

For motor Dimensions in mm (inches)

Shaft height	Type	DIN IEC	a ₁ P	b ₁ N	c ₁ LA	e ₁ M	f AB	f ₁ T	g ₂ –	h H	i ₂ –	s ₂ S	Encoder system: Resolver Absolute encoder AM16S/R / AM15DQ without/with brake		
													k LB	o ₁ –	o ₂ –
1FK7 High Dynamic, type of construction IM B5, natural cooling, with connector, with/without brake															
36	1FK7033-7		92 (3.62)	60 (2.36)	8 (0.31)	75 (2.95)	72 (2.83)	3 (0.12)	78 (3.07)	36 (1.42)	30 (1.18)	6.5 (0.26)	170/195 (6.69/7.68)	108/108 (4.25/4.25)	145/170 (5.71/6.69)
48	1FK7043-7		120 (4.72)	80 (3.15)	10 (0.39)	100 (3.94)	96 (3.78)	3 (0.12)	90 (3.54)	48 (1.89)	40 (1.57)	7 (0.28)	191/220 (7.52/8.66)	130/130 (5.12/5.12)	163/192 (6.42/7.56)
	1FK7044-7												216/245 (8.51/9.65)	155/155 (6.10/6.10)	188/217 (7.40/8.54)
63	1FK7061-7		155 (6.10)	110 (4.33)	10 (0.39)	130 (5.12)	126 (4.96)	3.5 (0.14)	105 (4.13)	63 (2.48)	50 (1.97)	9 (0.35)	185/228 (7.28/8.98)	121/121 (4.76/4.76)	153/196 (6.02/7.72)
	1FK7064-7												249/292 (9.80/11.50)	185/185 (7.28/7.28)	217/260 (8.54/10.24)
80	1FK7085-7		186 (7.32)	130 (5.12)	13 (0.51)	165 (6.50)	155 (6.10)	3.5 (0.14)	141.5 (5.57)	77.5 (3.05)	58 (2.28)	11 (0.43)	261/303 (10.28/11.93)	192/192 (7.56/7.56)	229/272 (9.02/10.71)
	1FK7086-7								140.5 (5.53)						

Shaft height	Type	DIN IEC	Encoder system: Incremental encoder IC2048S/R / IC22DQ Absolute encoder AM2048S/R / AM22DQ AM512S/R / AM20DQ AM32S/R / AM16DQ without/with brake			Shaft extension DE				
			k LB	o ₁ –	o ₂ –	d D	d ₆ –	l E	t GA	u F
36	1FK7033-7		194/219 (7.64/8.62)	109/109 (4.29/4.29)	144/168 (5.67/6.61)	14 (0.55)	M5	30 (1.18)	16 (0.63)	5 (0.20)
48	1FK7043-7		212/241 (8.35/9.49)	130/130 (5.12/5.12)	163/192 (6.42/7.56)	19 (0.75)	M6	40 (1.57)	21.5 (0.85)	6 (0.24)
	1FK7044-7		237/266 (9.33/10.47)	155/155 (6.10/6.10)	188/217 (7.40/8.54)					
63	1FK7061-7		208/251 (8.19/9.88)	121/121 (4.76/4.76)	154/197 (6.06/7.76)	24 (0.94)	M8	50 (1.97)	27 (1.06)	8 (0.31)
	1FK7064-7		272/315 (10.71/12.40)	185/185 (7.28/7.28)	218/261 (8.58/10.28)					
80	1FK7085-7		283/326 (11.14/12.83)	192/192 (7.56/7.56)	229/272 (9.02/10.71)	32 (1.26)	M12	58 (2.28)	35 (1.38)	10 (0.39)
	1FK7086-7									

1FK703.-7
1FK704.-7
1FK706.-7
1FK708.-7

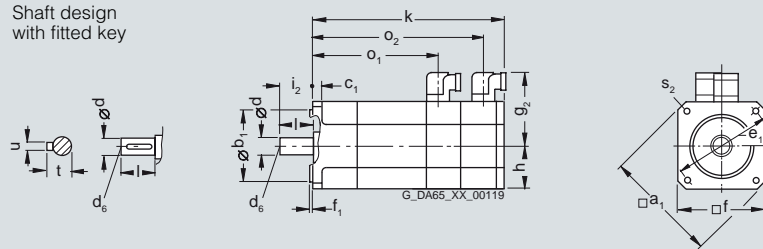
Shaft design
with fitted key

Dimensional drawings

For motor Dimensions in mm (inches)

Shaft height	Type	DIN IEC	a ₁ P	b ₁ N	c ₁ LA	e ₁ M	f AB	f ₁ T	g ₁ –	g ₂ –	i ₂ –	s ₂ S	Encoder system:					
													Incremental encoder			Absolute encoder		
													without brake			with brake		
													k LB	o ₁ –	o ₂ –	k LB	o ₁ –	o ₂ –
1FK7 High Inertia, natural cooling, with connector, with/without brake																		
48	1FK7042-3B		120 (4.72)	80 (3.15)	10 (0.39)	100 (3.94)	96 (3.78)	3 (0.12)	94 (3.7)	90 (3.54)	40 (1.57)	6.5 (0.26)	192 (7.56)	125 (4.92)	177 (6.97)	224 (8.82)	157 (6.18)	209 (8.23)
63	1FK7060-3B		155 (6.1)	110 (4.33)	10 (0.39)	130 (5.12)	126 (4.96)	3.5 (0.14)	102 (4.02)	104 (4.09)	50 (1.97)	9 (0.35)	187 (7.36)	120 (4.72)	172 (6.77)	222 (8.74)	155 (6.1)	207 (8.15)
	1FK7062-3B												221 (8.7)	153 (6.02)	205 (8.07)	256 (10.08)	189 (7.44)	241 (9.49)
80	1FK7081-3B		194 (7.64)	130 (5.12)	11.5 (0.45)	165 (6.5)	155 (6.1)	3.5 (0.14)	94 (3.7)	119 (4.69)	58 (2.28)	11 (0.43)	216 (8.5)	151 (5.94)	201 (7.91)	269 (10.59)	203 (7.99)	253 (9.96)
	1FK7084-3B												275 (10.8)	209 (8.23)	259 (10.2)	327 (12.87)	262 (10.3)	312 (12.28)

Shaft extension DE

Shaft height	Type	d D	d ₆ –	l E	t GA	u F
48	1FK7042-3B	19 (0.75)	M6	40 (1.57)	21.5 (0.85)	6 (0.24)
63	1FK7060-3B	24 (0.94)	M8	50 (1.97)	27 (1.06)	8 (0.31)
	1FK7062-3B					
80	1FK7081-3B	32 (1.26)	M12	58 (2.28)	35 (1.38)	10 (0.38)
	1FK7084-3B					

1FK7042-3B
1FK706.-3B
1FK708.-3B

